

# 3.2 EPIC® D A - V I N C I H - B

Anbaugehäuse / Panel mount base / Embase encastrée

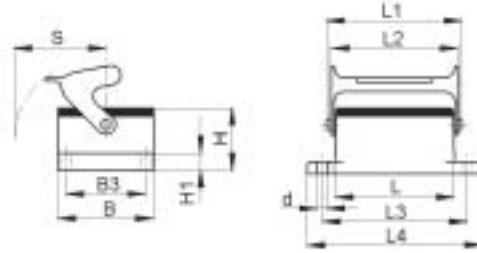

**EPIC® H-B Gehäuse: Anbaugehäuse (Längsbügel)**  
**EPIC® H-B housings: panel mount base (single locking lever)**  
**Boîtiers EPIC® H-B: embase encastrée (simple levier)**

## H-B 6

Artikel part article	Art.Nr. part No. N° art.	PG	L	L1	L2	L3	L4	B	B1	B2	B3	B4	B5	H	H1	H2	S	d
H-B 6 AG-LB	<b>10003000</b>		60	74,8	70	70	80	43			32			27,8	4		44	4,3

Einsätze / Inserts / Inserts: 1.4: H-BE 6 / 1.5: H-EE 10 / 1.9: H-DD 24 / 1.10: MC 6 / 1.11: TB H-BE 6  
 Deckel / Cover / Couvercle: 6.1: H-B 6

## H-B 10

Artikel part article	Art.Nr. part No. N° art.	PG	L	L1	L2	L3	L4	B	B1	B2	B3	B4	B5	H	H1	H2	S	d
H-B 10 AG-LB	<b>10032900</b>		73	91	88,5	83	93	43			32			27,8	4		50	4,3

Einsätze / Inserts / Inserts: 1.4: H-BE 10 / 1.5: H-EE 18 / 1.7: H-BVE 3 / 1.9: H-DD 42 / 1.10: MC 10 / 1.11: TB H-BE 10

## H-B 16

Artikel part article	Art.Nr. part No. N° art.	PG	L	L1	L2	L3	L4	B	B1	B2	B3	B4	B5	H	H1	H2	S	d
H-B 16 AG-LB	<b>10072900</b>		93,3	111	109,5	103	113	43			32			27,8	4		50	4,3

Einsätze / Inserts / Inserts: 1.4: H-BE 16 / 1.5: H-EE 32 / 1.6: H-BS 6 / 1.7: H-BVE 6 / 1.8: H-D 40 / 1.9: H-DD 72 / 1.10: MC 16 / 1.11: TB H-BE 16

## H-B 24

Artikel part article	Art.Nr. part No. N° art.	PG	L	L1	L2	L3	L4	B	B1	B2	B3	B4	B5	H	H1	H2	S	d
H-B 24 AG-LB	<b>10102900</b>		120	138	136,5	130	140	43			32			27,8	4		50	4,3

Einsätze / Inserts / Inserts: 1.4: H-BE 24 / 1.5: H-EE 46 / 1.7: H-BVE 10 / 1.8: H-D 64 / 1.9: H-DD 108 / 1.10: MC 24 / 1.11: TB H-BE 24

## H-B 48

Artikel part article	Art.Nr. part No. N° art.	PG	L	L1	L2	L3	L4	B	B1	B2	B3	B4	B5	H	H1	H2	S	d
H-B 48 AG-LB	<b>10161000</b>		132	152	139,5	148	165	90			70			39,5	10		105	7

Einsätze / Inserts / Inserts: 1.4: H-BE 48 / 1.5: H-EE 92 / 1.7: 2 x H-BVE 10 / 1.8: H-D 128 / 1.9: H-DD 216 / 1.10: 2 x MC 24 / 1.11: 2 x TB H-BE 24 & 2 x TB H-D 64

# 3.2 EPIC® D A - V I N C I H - B

Anbaugehäuse / Panel mount base / Embase encastrée

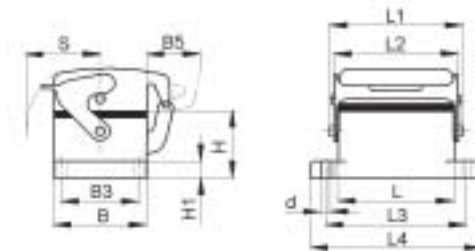

## EPIC® H-B Gehäuse: Anbaugehäuse (Schutzdeckel, Längsbügel)

EPIC® H-B housings: panel mount base (cover, single locking lever)

Boîtiers EPIC® H-B: embase encastrée (couvercle, simple levier)

### H-B 6

Artikel part article	Art.Nr. part No. N° art.	PG	L	L1	L2	L3	L4	B	B1	B2	B3	B4	B5	H	H1	H2	S	d
H-B 6 AD-LB	<b>10004000</b>		60	74,8	70	70	80	43			32		25	27,8	4		44	4,3

Einsätze / Inserts / Inserts: 1.4: H-BE 6 / 1.5: H-EE 10 / 1.9: H-DD 24 / 1.10: MC 6 / 1.11: TB H-BE 6

### H-B 10

Artikel part article	Art.Nr. part No. N° art.	PG	L	L1	L2	L3	L4	B	B1	B2	B3	B4	B5	H	H1	H2	S	d
H-B 10 AD-LB	<b>10033900</b>		73	91	88,5	83	93	43			32		25	27,8	4		50	4,3

Einsätze / Inserts / Inserts: 1.4: H-BE 10 / 1.5: H-EE 18 / 1.7: H-BVE 3 / 1.9: H-DD 42 / 1.10: MC 10 / 1.11: TB H-BE 10

### H-B 16

Artikel part article	Art.Nr. part No. N° art.	PG	L	L1	L2	L3	L4	B	B1	B2	B3	B4	B5	H	H1	H2	S	d
H-B 16 AD-LB	<b>10073900</b>		93,3	111	109,5	103	113	43			32		25	27,8	4		50	4,3

Einsätze / Inserts / Inserts: 1.4: H-BE 16 / 1.5: H-EE 32 / 1.6: H-BS 6 / 1.7: H-BVE 6 / 1.8: H-D 40 / 1.9: H-DD 72 / 1.10: MC 16 / 1.11: TB H-BE 16

### H-B 24

Artikel part article	Art.Nr. part No. N° art.	PG	L	L1	L2	L3	L4	B	B1	B2	B3	B4	B5	H	H1	H2	S	d
H-B 24 AD-LB	<b>10103900</b>		120	138	136,5	130	140	43			32		25	27,8	4		50	4,3

Einsätze / Inserts / Inserts: 1.4: H-BE 24 / 1.5: H-EE 46 / 1.7: H-BVE 10 / 1.8: H-D 64 / 1.9: H-DD 108 / 1.10: MC 24 / 1.11: TB H-BE 24

### H-B 48

Artikel part article	Art.Nr. part No. N° art.	PG	L	L1	L2	L3	L4	B	B1	B2	B3	B4	B5	H	H1	H2	S	d
H-B 48 AD-LB	<b>10152000</b>		132	152	139,5	148	165	90			70		30	39,5	10		105	7

Einsätze / Inserts / Inserts: 1.4: H-BE 48 / 1.5: H-EE 92 / 1.7: 2 x H-BVE 10 / 1.8: H-D 128 / 1.9: H-DD 216 / 1.10: 2 x MC 24 / 1.11: 2 x TB H-BE 24 & 2 x TB H-D 64

# 3.2 EPIC® D A - V I N C I H - B

Anbaugehäuse / Panel mount base / Embase encastrée

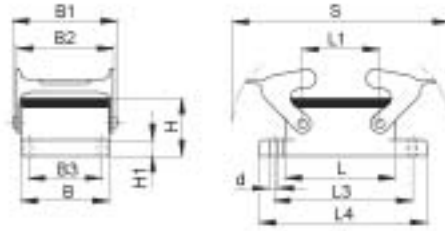

**EPIC® H-B Gehäuse: Anbaugehäuse (Querbügel)**  
**EPIC® H-B housings: panel mount base (double locking lever)**  
**Boîtiers EPIC® H-B: embase encastrée (double levier)**

## H-B 10

Artikel part article	Art.Nr. part No. N° art.	PG	L	L1	L2	L3	L4	B	B1	B2	B3	B4	B5	H	H1	H2	S	d
H-B 10 AG	<b>10032000</b>		73	27		83	93	43	57,8	53	32			27,8	4		116	4,3

Einsätze / Inserts / Inserts: 1.4: H-BE 10 / 1.5: H-EE 18 / 1.7: H-BVE 3 / 1.9: H-DD 42 / 1.10: MC 10 / 1.11: TB H-BE 10  
 Deckel / Cover / Couvercle: 6.1: H-B 10

## H-B 16

Artikel part article	Art.Nr. part No. N° art.	PG	L	L1	L2	L3	L4	B	B1	B2	B3	B4	B5	H	H1	H2	S	d
H-B 16 AG	<b>10072000</b>		93,3	47,5		103	113	43	57,8	53	32			27,8	4		136,5	4,3

Einsätze / Inserts / Inserts: 1.4: H-BE 16 / 1.5: H-EE 32 / 1.6: H-BS 6 / 1.7: H-BVE 6 / 1.8: H-D 40 / 1.9: H-DD 72 / 1.10: MC 16 /  
 1.11: TB H-BE 16  
 Deckel / Cover / Couvercle: 6.1: H-B 16

## H-B 24

Artikel part article	Art.Nr. part No. N° art.	PG	L	L1	L2	L3	L4	B	B1	B2	B3	B4	B5	H	H1	H2	S	d
H-B 24 AG	<b>10102000</b>		120	74		130	140	43	57,8	53	32			27,8	4		163	4,3

Einsätze / Inserts / Inserts: 1.4: H-BE 24 / 1.5: H-EE 46 / 1.7: H-BVE 10 / 1.8: H-D 64 / 1.9: H-DD 108 / 1.10: MC 24 /  
 1.11: TB H-BE 24  
 Deckel / Cover / Couvercle: 6.1: H-B 24

## H-B 32

Artikel part article	Art.Nr. part No. N° art.	Art.Nr.: EP part No.: EP N° art.: EP	PG	L	L1	L2	L3	L4	B	B1	B2	B3	B4	B5	H	H1	H2	S	d
H-B 32 AG	<b>10132000</b>			93,5	64,5		110	124	79	93,8	87,8	65			30,3	5		136,5	5,5

Einsätze / Inserts / Inserts: 1.4: H-BE 32 / 1.5: H-EE 64 / 1.6: H-BS 12 / 1.8: H-D 80 / 1.9: H-DD 144 / 1.10: 2 x MC 24 /  
 1.11: 2 x TB H-BE 16 & 2 x TB H-D 40

# 3.2 EPIC® D A - V I N C I H - B

Anbaugehäuse / Panel mount base / Embase encastrée

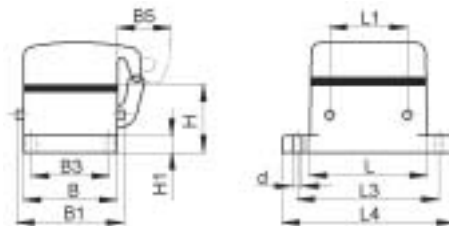

## EPIC® H-B Gehäuse: Anbaugehäuse (Schutzdeckel, Bolzen für Querbügel)

EPIC® H-B housings: panel mount base (cover, bolts for double locking lever)

Boîtiers EPIC® H-B: embase encastrée (couvercle, ergots pour double levier)

### H-B 10

Artikel part article	Art.Nr. part No. N° art.	PG	L	L1	L2	L3	L4	B	B1	B2	B3	B4	B5	H	H1	H2	S	d
H-B 10 AD-BO	<b>10033000</b>		73	27		83	93	43	57,8		32		25	27,8	4			4,3

Einsätze / Inserts / Inserts: 1.4: H-BE 10 / 1.5: H-EE 18 / 1.7: H-BVE 3 / 1.9: H-DD 42 / 1.10: MC 10 / 1.11: TB H-BE 10

### H-B 16

Artikel part article	Art.Nr. part No. N° art.	PG	L	L1	L2	L3	L4	B	B1	B2	B3	B4	B5	H	H1	H2	S	d
H-B 16 AD-BO	<b>10073000</b>		93,3	47,5		103	113	43	57,8		32		25	27,8	4			4,3

Einsätze / Inserts / Inserts: 1.4: H-BE 16 / 1.5: H-EE 32 / 1.6: H-BS 6 / 1.7: H-BVE 6 / 1.8: H-D 40 / 1.9: H-DD 72 / 1.10: MC 16 / 1.11: TB H-BE 16

### H-B 24

Artikel part article	Art.Nr. part No. N° art.	PG	L	L1	L2	L3	L4	B	B1	B2	B3	B4	B5	H	H1	H2	S	d
H-B 24 AD-BO	<b>10103000</b>		120	74		130	140	43	57,8		32		25	27,8	4			4,3

Einsätze / Inserts / Inserts: 1.4: H-BE 24 / 1.5: H-EE 46 / 1.7: H-BVE 10 / 1.8: H-D 64 / 1.9: H-DD 108 / 1.10: MC 24 / 1.11: TB H-BE 24

# 3.2 EPIC® D A - V I N C I H - B

Sockelgehäuse / Surface mount base / Embase en saillie



PG / M

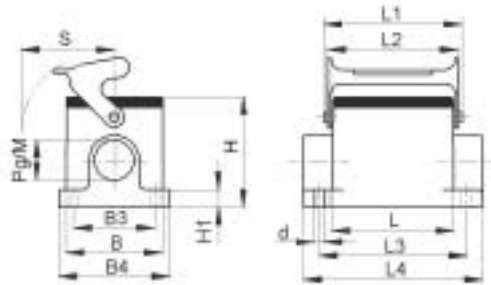

**EPIC® H-B Gehäuse: Sockelgehäuse (2 Kabeleingänge, Längsbügel)**  
**EPIC® H-B housings: surface mount base (2 cable entries, single locking lever)**  
**Boîtiers EPIC® H-B: embase en saillie (2 entrées de câble, simple levier)**

## H-B 6

Artikel part article	Art.Nr. part No. N° art.	PG	M	L	L1	L2	L3	L4	B	B1	B2	B3	B4	B5	H	H1	H2	S	d
H-B 6 SGRL 16	<b>10006000</b>	16		60	74,8	70	70	84	43			40	52		57	4,5		44	5,5
H-B 6 SGRL M20	<b>19006000</b>		20	60	74,8	70	70	84	43			40	52		57	4,5		44	5,5
H-B 6 SGRL M25	<b>79006600</b>		25																

Einsätze / Inserts / Inserts: 1.4: H-BE 6 / 1.5: H-EE 10 / 1.9: H-DD 24 / 1.10: MC 6

Deckel / Cover / Couvercle: 6.1: H-B 6

Kabelverschraubung / Cable gland / Presse-étoupe: 5.1: Metr. / 5.2: PG / 5.3: Kit

## H-B 10

Artikel part article	Art.Nr. part No. N° art.	PG	M	L	L1	L2	L3	L4	B	B1	B2	B3	B4	B5	H	H1	H2	S	d
H-B 10 SGRL-LB 16	<b>10035900</b>	16		73	91	88,5	82	94	43			40	52		57	4,5		50	5,5
H-B 10 SGRL-LB M20	<b>19035900</b>		20	73	91	88,5	82	94	43			40	52		57	4,5		50	5,5
H-B 10 SGRL-LB M25	<b>79061600</b>		25																

Einsätze / Inserts / Inserts: 1.4: H-BE 10 / 1.5: H-EE 18 / 1.7: H-BVE 3 / 1.9: H-DD 42 / 1.10: MC 10

Kabelverschraubung / Cable gland / Presse-étoupe: 5.1: Metr. / 5.2: PG / 5.3: Kit

## H-B 16

Artikel part article	Art.Nr. part No. N° art.	PG	M	L	L1	L2	L3	L4	B	B1	B2	B3	B4	B5	H	H1	H2	S	d
H-B 16 SGRL-LB 21	<b>10075900</b>	21		93	111	109,5	105	117	43			45	57		64	4,5		50	5,5
H-B 16 SGRL-LB M25	<b>19075900</b>		25	93	111	109,5	105	117	43			45	57		64	4,5		50	5,5

Einsätze / Inserts / Inserts: 1.4: H-BE 16 / 1.5: H-EE 32 / 1.6: H-BS 6 / 1.7: H-BVE 6 / 1.8: H-D 40 / 1.9: H-DD 72 / 1.10: MC 16

Kabelverschraubung / Cable gland / Presse-étoupe: 5.1: Metr. / 5.2: PG / 5.3: Kit

## 3.2 EPIC® D A - V I N C I H - B

Sockelgehäuse / Surface mount base / Embase en saillie



PG / M

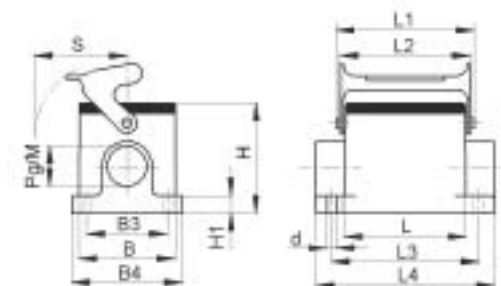

**EPIC® H-B Gehäuse: Sockelgehäuse (2 Kabeleingänge, Längsbügel)**

*EPIC® H-B housings: surface mount base (2 cable entries, single locking lever)*

**Boîtiers EPIC® H-B: embase en saillie (2 entrées de câble, simple levier)**

### H-B 24

Artikel part article	Art.Nr. part No. N° art.	PG	M	L	L1	L2	L3	L4	B	B1	B2	B3	B4	B5	H	H1	H2	S	d
H-B 24 SGRL-LB 21	<b>10105900</b>		21	120	138	136,5	132	144	43			45	57		64	4,5		50	5,5
H-B 24 SGRL-LB M25	<b>19105900</b>		25	120	138	136,5	132	144	43			45	57		64	4,5		50	5,5

Einsätze / Inserts / Inserts: 1.4: H-BE 24 / 1.5: H-EE 46 / 1.7: H-BVE 10 / 1.8: H-D 64 / 1.9: H-DD 108 / 1.10: MC 24

Kabelverschraubung / Cable gland / Presse-étoupe: 5.1: Metr. / 5.2: PG / 5.3: Kit

### H-B 48

Artikel part article	Art.Nr. part No. N° art.	PG	M	L	L1	L2	L3	L4	B	B1	B2	B3	B4	B5	H	H1	H2	S	d
H-B 48 SGRL 29	<b>10166000</b>		29		132	152	139,5	111	132	90		106	120		100	12		105	6,5
H-B 48 SGRL 36	<b>10166100</b>		36		132	152	139,5	111	132	90		106	120		100	12		105	6,5
H-B 48 SGRL M32	<b>19166000</b>		32		132	152	139,5	111	132	90		106	120		100	12		105	6,5
H-B 48 SGRL M40	<b>19166100</b>		40		132	152	139,5	111	132	90		106	120		100	12		105	6,5

Einsätze / Inserts / Inserts: 1.4: H-BE 48 / 1.5: H-EE 92 / 1.7: 2 x H-BVE 10 / 1.8: H-D 128 / 1.9: H-DD 216 / 1.10: 2 x MC 24

Kabelverschraubung / Cable gland / Presse-étoupe: 5.1: Metr. / 5.2: PG / 5.3: Kit

# 3.2 EPIC® D A - V I N C I H - B

Sockelgehäuse / Surface mount base / Embase en saillie



PG / M

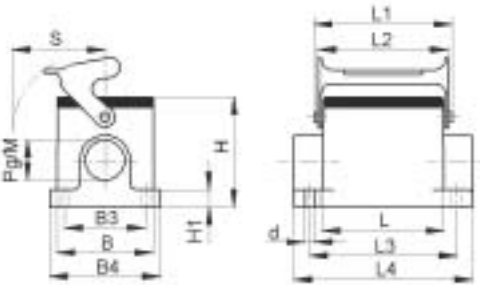

**EPIC® H-B Gehäuse: Sockelgehäuse (2 Kabeleingänge, Längsbügel, hohe Bauform)**

*EPIC® H-B housings: surface mount base (2 cable entries, single locking lever, high version)*

**Boîtiers EPIC® H-B: embase en saillie (2 entrées de câble, simple levier, version haute)**

## H-B 6

Artikel part article	Art.Nr. part No. N° art.	PG	M	L	L1	L2	L3	L4	B	B1	B2	B3	B4	B5	H	H1	H2	S	d
H-B 6 SGR LH 21	<b>70006200</b>	21		60	74,8	70	70	84	43			45	58		74	6		44	5,5
H-B 6 SGR LH 29	<b>70006400</b>	29																	
H-B 6 SGR LH M25	<b>79006200</b>		25	60	74,8	70	70	84	43			45	58		74	6		44	5,5
H-B 6 SGR LH M32	<b>79006400</b>		32																

Einsätze / Inserts / Inserts: 1.4: H-BE 6 / 1.5: H-EE 10 / 1.9: H-DD 24 / 1.10: MC 6

Deckel / Cover / Couvercle: 6.1: H-B 6

Kabelverschraubung / Cable gland / Presse-étoupe: 5.1: Metr. / 5.2: PG / 5.3: Kit

## H-B 10

Artikel part article	Art.Nr. part No. N° art.	PG	M	L	L1	L2	L3	L4	B	B1	B2	B3	B4	B5	H	H1	H2	S	d
H-B 10 SGR LH-LB 21	<b>70061200</b>	21		73	91	88,5	82	97	43			45	58		74	6		50	5,5
H-B 10 SGR LH-LB 29	<b>70061400</b>	29																	
H-B 10 SGR LH-LB M25	<b>79061200</b>		25	73	91	88,5	82	97	43			45	58		74	6		50	5,5
H-B 10 SGR LH-LB M32	<b>79061400</b>		32																

Einsätze / Inserts / Inserts: 1.4: H-BE 10 / 1.5: H-EE 18 / 1.7: H-BVE 3 / 1.9: H-DD 42 / 1.10: MC 10

Kabelverschraubung / Cable gland / Presse-étoupe: 5.1: Metr. / 5.2: PG / 5.3: Kit

## 3.2 EPIC® D A - V I N C I H - B

Sockelgehäuse / Surface mount base / Embase en saillie



PG / M

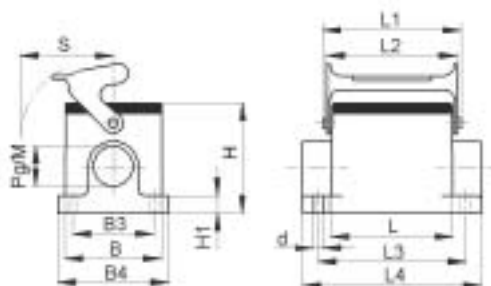

**EPIC® H-B Gehäuse: Sockelgehäuse (2 Kabeleingänge, Längsbügel, hohe Bauform)**

**EPIC® H-B housings: surface mount base (2 cable entries, single locking lever, high version)**

**Boîtiers EPIC® H-B: embase en saillie (2 entrées de câble, simple levier, version haute)**

### H-B 16

Artikel part article	Art.Nr. part No. N° art.	PG	M	L	L1	L2	L3	L4	B	B1	B2	B3	B4	B5	H	H1	H2	S	d
H-B 16 SGR LH-LB 21	<b>70111200</b>	21		93,3	111	109,5	105	117	43			45	58		84	6		50	5,5
H-B 16 SGR LH-LB 29	<b>70111400</b>	29																	
H-B 16 SGR LH-LB M25	<b>79111200</b>		25	93,3	111	109,5	105	117	43			45	58		84	6		50	5,5
H-B 16 SGR LH-LB M32	<b>79111400</b>		32																

Einsätze / Inserts / Inserts: 1.4: H-BE 16 / 1.5: H-EE 32 / 1.6: H-BS 6 / 1.7: H-BVE 6 / 1.8: H-D 40 / 1.9: H-DD 72 / 1.10: MC 16  
Kabelverschraubung / Cable gland / Presse-étoupe: 5.1: Metr. / 5.2: PG / 5.3: Kit

### H-B 24

Artikel part article	Art.Nr. part No. N° art.	PG	M	L	L1	L2	L3	L4	B	B1	B2	B3	B4	B5	H	H1	H2	S	d
H-B 24 SGR LH-LB 21	<b>70161200</b>	21		120	138	136,5	132	144	43			45	58		84	6		50	5,5
H-B 24 SGR LH-LB 29	<b>70161400</b>	29																	
H-B 24 SGR LH-LB M25	<b>79161200</b>		25	120	138	136,5	132	144	43			45	58		84	6		50	5,5
H-B 24 SGR LH-LB M32	<b>79161400</b>		32																

Einsätze / Inserts / Inserts: 1.4: H-BE 24 / 1.5: H-EE 46 / 1.7: H-BVE 10 / 1.8: H-D 64 / 1.9: H-DD 108 / 1.10: MC 24  
Kabelverschraubung / Cable gland / Presse-étoupe: 5.1: Metr. / 5.2: PG / 5.3: Kit



# 3.2 EPIC® D A - V I N C I H - B

Sockelgehäuse / Surface mount base / Embase en saillie



PG / M

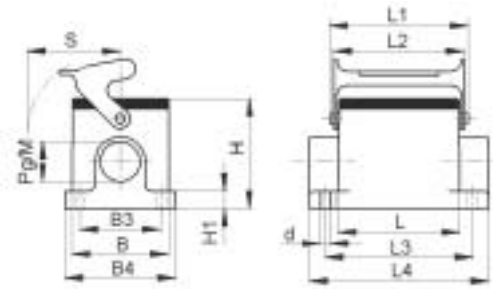

**EPIC® H-B Gehäuse: Sockelgehäuse (1 Kabeleingang, Längsbügel)**

*EPIC® H-B housings: surface mount base (1 cable entry, single locking lever)*

**Boîtiers EPIC® H-B: embase en saillie (1 entrée de câble, simple levier)**

## H-B 6

Artikel part article	Art.Nr. part No. N° art.	PG	M	L	L1	L2	L3	L4	B	B1	B2	B3	B4	B5	H	H1	H2	S	d
H-B 6 SGR 16	<b>10005000</b>	16		60	74,8	70	70	84	43			40	52		57	4,5		44	5,5
H-B 6 SGR M20	<b>19005000</b>		20	60	74,8	70	70	84	43			40	52		57	4,5		44	5,5
H-B 6 SGR M25	<b>79005600</b>		25																

Einsätze / Inserts / Inserts: 1.4: H-BE 6 / 1.5: H-EE 10 / 1.9: H-DD 24 / 1.10: MC 6

Deckel / Cover / Couvercle: 6.1: H-B 6

Kabelverschraubung / Cable gland / Presse-étoupe: 5.1: Metr. / 5.2: PG / 5.3: Kit

## H-B 10

Artikel part article	Art.Nr. part No. N° art.	PG	M	L	L1	L2	L3	L4	B	B1	B2	B3	B4	B5	H	H1	H2	S	d
H-B 10 SGR-LB 16	<b>10034900</b>	16		73	91	88,5	82	94	43			40	52		57	4,5		50	5,5
H-B 10 SGR-LB 21	<b>10034700</b>	21																	
H-B 10 SGR-LB M20	<b>19034900</b>		20	73	91	88,5	82	94	43			40	52		57	4,5		50	5,5
H-B 10 SGR-LB M25	<b>19034700</b>		25																

Einsätze / Inserts / Inserts: 1.4: H-BE 10 / 1.5: H-EE 18 / 1.7: H-BVE 3 / 1.9: H-DD 42 / 1.10: MC 10

Kabelverschraubung / Cable gland / Presse-étoupe: 5.1: Metr. / 5.2: PG / 5.3: Kit

## H-B 16

Artikel part article	Art.Nr. part No. N° art.	PG	M	L	L1	L2	L3	L4	B	B1	B2	B3	B4	B5	H	H1	H2	S	d
H-B 16 SGR-LB 21	<b>10074900</b>	21		93	111	109,5	105	117	43			45	57		64	4,5		50	5,5
H-B 16 SGR-LB M25	<b>19074900</b>		25	93	111	109,5	105	117	43			45	57		64	4,5		50	5,5

Einsätze / Inserts / Inserts: 1.4: H-BE 16 / 1.5: H-EE 32 / 1.6: H-BS 6 / 1.7: H-BVE 6 / 1.8: H-D 40 / 1.9: H-DD 72 / 1.10: MC 16

Kabelverschraubung / Cable gland / Presse-étoupe: 5.1: Metr. / 5.2: PG / 5.3: Kit

## 3.2 EPIC® D A - V I N C I H - B

Sockelgehäuse / Surface mount base / Embase en saillie



PG / M

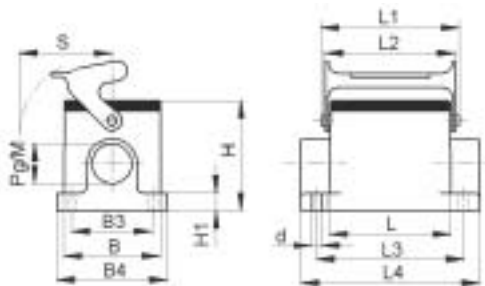

**EPIC® H-B Gehäuse: Sockelgehäuse (1 Kabeleingang, Längsbügel)**

**EPIC® H-B housings: surface mount base (1 cable entry, single locking lever)**

**Boîtiers EPIC® H-B: embase en saillie (1 entrée de câble, simple levier)**

### H-B 24

Artikel part article	Art.Nr. part No. N° art.	PG	M	L	L1	L2	L3	L4	B	B1	B2	B3	B4	B5	H	H1	H2	S	d
H-B 24 SGR-LB 21	<b>10104900</b>		21	120	138	136,5	132	144	43			45	57		64	4,5		50	5,5
H-B 24 SGR-LB M25	<b>19104900</b>		25	120	138	136,5	132	144	43			45	57		64	4,5		50	5,5

Einsätze / Inserts / Inserts: 1.4: H-BE 24 / 1.5: H-EE 46 / 1.7: H-BVE 10 / 1.8: H-D 64 / 1.9: H-DD 108 / 1.10: MC 24

Kabelverschraubung / Cable gland / Presse-étoupe: 5.1: Metr. / 5.2: PG / 5.3: Kit

### H-B 48

Artikel part article	Art.Nr. part No. N° art.	PG	M	L	L1	L2	L3	L4	B	B1	B2	B3	B4	B5	H	H1	H2	S	d
H-B 48 SGR 29	<b>10165000</b>		29		132	152	139,5	111	132	90		106	120		100	12		105	6,5
H-B 48 SGR 36	<b>10165100</b>		36		132	152	139,5	111	132	90		106	120		100	12		105	6,5
H-B 48 SGR M32	<b>19165000</b>		32		132	152	139,5	111	132	90		106	120		100	12		105	6,5
H-B 48 SGR M40	<b>19165100</b>		40		132	152	139,5	111	132	90		106	120		100	12		105	6,5

Einsätze / Inserts / Inserts: 1.4: H-BE 48 / 1.5: H-EE 92 / 1.7: 2 x H-BVE 10 / 1.8: H-D 128 / 1.9: H-DD 216 / 1.10: 2 x MC 24

Kabelverschraubung / Cable gland / Presse-étoupe: 5.1: Metr. / 5.2: PG / 5.3: Kit

## 3.2 EPIC® D A - V I N C I H - B

Sockelgehäuse / Surface mount base / Embase en saillie



PG / M

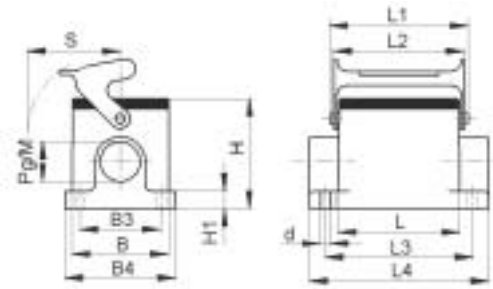

**EPIC® H-B Gehäuse: Sockelgehäuse (1 Kabeleingang, Längsbügel, hohe Bauform)**

*EPIC® H-B housings: surface mount base (1 cable entry, single locking lever, high version)*

**Boîtiers EPIC® H-B: embase en saillie (1 entrée de câble, simple levier, version haute)**

### H-B 6

Artikel part article	Art.Nr. part No. N° art.	PG	M	L	L1	L2	L3	L4	B	B1	B2	B3	B4	B5	H	H1	H2	S	d
H-B 6 SGRH-LB 21	<b>70005200</b>	21		60	74,8	70	70	84	43			45	58		74	6		44	5,5
H-B 6 SGRH-LB 29	<b>70005400</b>	29																	
H-B 6 SGRH-LB M25	<b>79005200</b>		25	60	74,8	70	70	84	43			45	58		74	6		44	5,5
H-B 6 SGRH-LB M32	<b>79005400</b>		32																

Einsätze / Inserts / Inserts: 1.4: H-BE 6 / 1.5: H-EE 10 / 1.9: H-DD 24 / 1.10: MC 6

Deckel / Cover / Couverture: 6.1: H-B 6

Kabelverschraubung / Cable gland / Presse-étoupe: 5.1: Metr. / 5.2: PG / 5.3: Kit

### H-B 10

Artikel part article	Art.Nr. part No. N° art.	PG	M	L	L1	L2	L3	L4	B	B1	B2	B3	B4	B5	H	H1	H2	S	d
H-B 10 SGRH-LB 21	<b>70060200</b>	21		73	91	88,5	82	97	43			45	58		74	6		50	5,5
H-B 10 SGRH-LB 29	<b>70060400</b>	29																	
H-B 10 SGRH-LB M25	<b>79060200</b>		25	73	91	88,5	82	97	43			45	58		74	6		50	5,5
H-B 10 SGRH-LB M32	<b>79060400</b>		32																

Einsätze / Inserts / Inserts: 1.4: H-BE 10 / 1.5: H-EE 18 / 1.7: H-BVE 3 / 1.9: H-DD 42 / 1.10: MC 10

Kabelverschraubung / Cable gland / Presse-étoupe: 5.1: Metr. / 5.2: PG / 5.3: Kit

## 3.2 EPIC® D A - V I N C I H - B

Sockelgehäuse / Surface mount base / Embase en saillie



PG / M

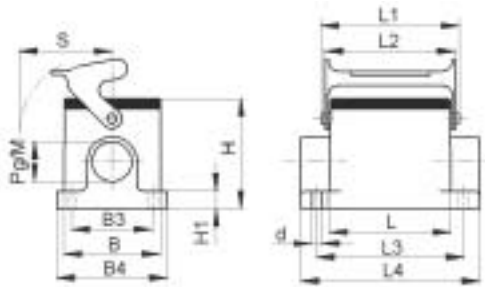

**EPIC® H-B Gehäuse: Sockelgehäuse (1 Kabeleingang, Längsbügel, hohe Bauform)**

**EPIC® H-B housings: surface mount base (1 cable entry, single locking lever, high version)**

**Boîtiers EPIC® H-B: embase en saillie (1 entrée de câble, simple levier, version haute)**

### H-B 16

Artikel part article	Art.Nr. part No. N° art.	PG	M	L	L1	L2	L3	L4	B	B1	B2	B3	B4	B5	H	H1	H2	S	d
H-B 16 SGRH-LB 21	<b>70110200</b>	21		93,3	111	109,5	105	117	43			45	58		84	6		50	5,5
H-B 16 SGRH-LB 29	<b>70110400</b>	29																	
H-B 16 SGRH-LB M25	<b>79110200</b>		25	93,3	111	109,5	105	117	43			45	58		84	6		50	5,5
H-B 16 SGRH-LB M32	<b>79110400</b>		32																

Einsätze / Inserts / Inserts: 1.4: H-BE 16 / 1.5: H-EE 32 / 1.6: H-BS 6 / 1.7: H-BVE 6 / 1.8: H-D 40 / 1.9: H-DD 72 / 1.10: MC 16  
Kabelverschraubung / Cable gland / Presse-étoupe: 5.1: Metr. / 5.2: PG / 5.3: Kit

### H-B 24

Artikel part article	Art.Nr. part No. N° art.	PG	M	L	L1	L2	L3	L4	B	B1	B2	B3	B4	B5	H	H1	H2	S	d
H-B 24 SGRH-LB 21	<b>70160200</b>	21		120	138	136,5	132	144	43			45	58		84	6		50	5,5
H-B 24 SGRH-LB 29	<b>70160400</b>	29																	
H-B 24 SGRH-LB M25	<b>79160200</b>		25	120	138	136,5	132	144	43			45	58		84	6		50	5,5
H-B 24 SGRH-LB M32	<b>79160400</b>		32																

Einsätze / Inserts / Inserts: 1.4: H-BE 24 / 1.5: H-EE 46 / 1.7: H-BVE 10 / 1.8: H-D 64 / 1.9: H-DD 108 / 1.10: MC 24  
Kabelverschraubung / Cable gland / Presse-étoupe: 5.1: Metr. / 5.2: PG / 5.3: Kit

# 3.2 EPIC® D A - V I N C I H - B

Sockelgehäuse / Surface mount base / Embase en saillie



PG / M

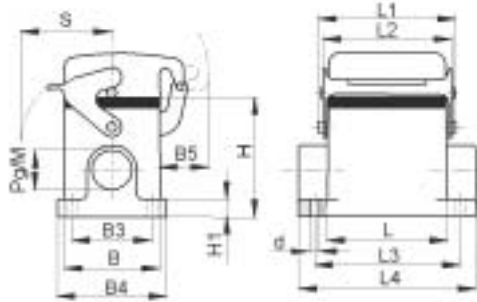

**EPIC® H-B Gehäuse: Sockelgehäuse (Schutzdeckel, 2 Kabeleingänge, Längsbügel)**

*EPIC® H-B housings: surface mount base (cover, 2 cable entries, single locking lever)*

**Boîtiers EPIC® H-B: embase en saillie (couvercle, 2 entrées de câble, simple levier)**

## H-B 6

Artikel part article	Art.Nr. part No. N° art.	PG	M	L	L1	L2	L3	L4	B	B1	B2	B3	B4	B5	H	H1	H2	S	d
H-B 6 SDRL-LB 16	<b>10009000</b>	16		60	74,8	70	70	84	43			40	52	25	57	4,5		44	5,5
H-B 6 SDRL-LB M20	<b>19009000</b>		20	60	74,8	70	70	84	43			40	52	25	57	4,5		44	5,5
H-B 6 SDRL-LB M25	<b>79016600</b>		25																

Einsätze / Inserts / Inserts: 1.4: H-BE 6 / 1.5: H-EE 10 / 1.9: H-DD 24 / 1.10: MC 6

Kabelverschraubung / Cable gland / Presse-étoupe: 5.1: Metr. / 5.2: PG / 5.3: Kit

## H-B 10

Artikel part article	Art.Nr. part No. N° art.	PG	M	L	L1	L2	L3	L4	B	B1	B2	B3	B4	B5	H	H1	H2	S	d
H-B 10 SDRL-LB 16	<b>10038900</b>	16		73	91	88,5	82	94	43			40	52	25	57	4,5		50	5,5
H-B 10 SDRL-LB M20	<b>19038900</b>		20	73	91	88,5	82	94	43			40	52	25	57	4,5		50	5,5
H-B 10 SDRL-LB M25	<b>79065600</b>		25	73	91	88,5	82	94	43			40	52	25	57	4,5		50	5,5

Einsätze / Inserts / Inserts: 1.4: H-BE 10 / 1.5: H-EE 18 / 1.7: H-BVE 3 / 1.9: H-DD 42 / 1.10: MC 10

Kabelverschraubung / Cable gland / Presse-étoupe: 5.1: Metr. / 5.2: PG / 5.3: Kit

## H-B 16

Artikel part article	Art.Nr. part No. N° art.	PG	M	L	L1	L2	L3	L4	B	B1	B2	B3	B4	B5	H	H1	H2	S	d
H-B 16 SDRL-LB 21	<b>10078900</b>	21		93	111	109,5	105	117	43			45	57	25	64	4,5		50	5,5
H-B 16 SDRL-LB M25	<b>19078900</b>		25	93	111	109,5	105	117	43			45	57	25	64	4,5		50	5,5

Einsätze / Inserts / Inserts: 1.4: H-BE 16 / 1.5: H-EE 32 / 1.6: H-BS 6 / 1.7: H-BVE 6 / 1.8: H-D 40 / 1.9: H-DD 72 / 1.10: MC 16

Kabelverschraubung / Cable gland / Presse-étoupe: 5.1: Metr. / 5.2: PG / 5.3: Kit

## 3.2 EPIC® D A - V I N C I H - B

Sockelgehäuse / Surface mount base / Embase en saillie



PG / M

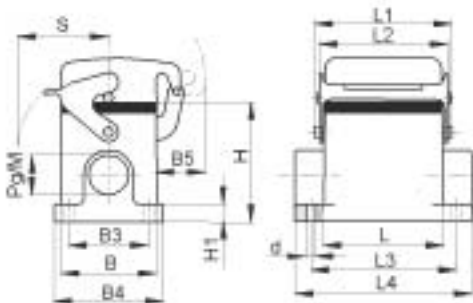

**EPIC® H-B Gehäuse: Sockelgehäuse (Schutzdeckel, 2 Kabeleingänge, Längsbügel)**

**EPIC® H-B housings: surface mount base (cover, 2 cable entries, single locking lever)**

**Boîtiers EPIC® H-B: embase en saillie (couverture, 2 entrées de câble, simple levier)**

### H-B 24

Artikel part article	Art.Nr. part No. N° art.	PG	M	L	L1	L2	L3	L4	B	B1	B2	B3	B4	B5	H	H1	H2	S	d
H-B 24 SDRL-LB 21	<b>10109900</b>		21	120	138	136,5	132	144	43			45	57	25	64	4,5		50	5,5
H-B 24 SDRL-LB M25	<b>19109900</b>		25	120	138	136,5	132	144	43			45	57	25	64	4,5		50	5,5

Einsätze / Inserts / Inserts: 1.4: H-BE 24 / 1.5: H-EE 46 / 1.7: H-BVE 10 / 1.8: H-D 64 / 1.9: H-DD 108 / 1.10: MC 24

Kabelverschraubung / Cable gland / Presse-étoupe: 5.1: Metr. / 5.2: PG / 5.3: Kit

### H-B 48

Artikel part article	Art.Nr. part No. N° art.	PG	M	L	L1	L2	L3	L4	B	B1	B2	B3	B4	B5	H	H1	H2	S	d
H-B 48 SDRL 29	<b>10168000</b>		29		132	152	139,5	111	132	90		106	120	30	100	12		105	6,5
H-B 48 SDRL 36	<b>10168100</b>		36		132	152	139,5	111	132	90		106	120	30	100	12		105	6,5
H-B 48 SDRL M32	<b>19168000</b>		32		132	152	139,5	111	132	90		106	120	30	100	12		105	6,5
H-B 48 SDRL M40	<b>19168100</b>		40		132	152	139,5	111	132	90		106	120	30	100	12		105	6,5

Einsätze / Inserts / Inserts: 1.4: H-BE 48 / 1.5: H-EE 92 / 1.7: 2 x H-BVE 10 / 1.8: H-D 128 / 1.9: H-DD 216 / 1.10: 2 x MC 24

Kabelverschraubung / Cable gland / Presse-étoupe: 5.1: Metr. / 5.2: PG / 5.3: Kit

## 3.2 EPIC® D A - V I N C I H - B

Sockelgehäuse / Surface mount base / Embase en saillie



PG / M

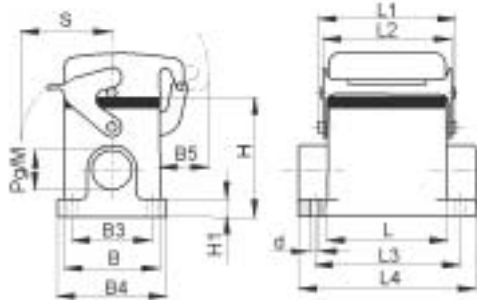

**EPIC® H-B Gehäuse: Sockelgehäuse (Schutzdeckel, 2 Kabeleingänge, Längsbügel, hohe Bauform)**

**EPIC® H-B housings: surface mount base (cover, 2 cable entries, single locking lever, high version)**

**Boîtiers EPIC® H-B: embase en saillie (couvercle, 2 entrées de câble, simple levier, version haute)**

### H-B 6

Artikel part article	Art.Nr. part No. N° art.	PG	M	L	L1	L2	L3	L4	B	B1	B2	B3	B4	B5	H	H1	H2	S	d
H-B 6 SDRHL-LB 21	<b>70016200</b>	21		60	74,8	70	70	84	43			45	58	25	74	6		44	5,5
H-B 6 SDRHL-LB 29	<b>70016400</b>	29																	
H-B 6 SDRHL-LB M25	<b>79016200</b>		25	60	74,8	70	70	84	43			45	58	25	74	6		44	5,5
H-B 6 SDRHL-LB M32	<b>79016400</b>		32																

Einsätze / Inserts / Inserts: 1.4: H-BE 6 / 1.5: H-EE 10 / 1.9: H-DD 24 / 1.10: MC 6

Kabelverschraubung / Cable gland / Presse-étoupe: 5.1: Metr. / 5.2: PG / 5.3: Kit

### H-B 10

Artikel part article	Art.Nr. part No. N° art.	PG	M	L	L1	L2	L3	L4	B	B1	B2	B3	B4	B5	H	H1	H2	S	d
H-B 10 SDRHL-LB 21	<b>70065200</b>	21		73	91	88,5	82	97	43			45	58	25	74	6		50	5,5
H-B 10 SDRHL-LB 29	<b>70065400</b>	29																	
H-B 10 SDRHL-LB M25	<b>79065200</b>		25	73	91	88,5	82	97	43			45	58	25	74	6		50	5,5
H-B 10 SDRHL-LB M32	<b>79065400</b>		32																

Einsätze / Inserts / Inserts: 1.4: H-BE 10 / 1.5: H-EE 18 / 1.7: H-BVE 3 / 1.9: H-DD 42 / 1.10: MC 10

Kabelverschraubung / Cable gland / Presse-étoupe: 5.1: Metr. / 5.2: PG / 5.3: Kit

## 3.2 EPIC® D A - V I N C I H - B

Sockelgehäuse / Surface mount base / Embase en saillie



PG / M

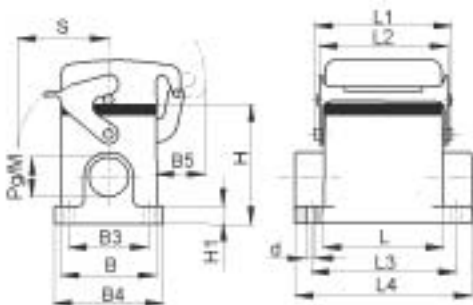

**EPIC® H-B Gehäuse: Sockelgehäuse (Schutzdeckel, 2 Kabeleingänge, Längsbügel, hohe Bauform)**

**EPIC® H-B housings: surface mount base (cover, 2 cable entries, single locking lever, high version)**

**Boîtiers EPIC® H-B: embase en saillie (couverture, 2 entrées de câble, simple levier, version haute)**

### H-B 16

Artikel part article	Art.Nr. part No. N° art.	PG	M	L	L1	L2	L3	L4	B	B1	B2	B3	B4	B5	H	H1	H2	S	d
H-B 16 SDRHLH-LB 21	<b>70115200</b>	21		93,3	111	109,5	105	117	43			45	58	25	84	6		50	5,5
H-B 16 SDRHLH-LB 29	<b>70115400</b>	29																	
H-B 16 SDRHLH-LB M25	<b>79115200</b>		25	93,3	111	109,5	105	117	43			45	58	25	84	6		50	5,5
H-B 16 SDRHLH-LB M32	<b>79115400</b>		32																

Einsätze / Inserts / Inserts: 1.4: H-BE 16 / 1.5: H-EE 32 / 1.6: H-BS 6 / 1.7: H-BVE 6 / 1.8: H-D 40 / 1.9: H-DD 72 / 1.10: MC 16  
Kabelverschraubung / Cable gland / Presse-étoupe: 5.1: Metr. / 5.2: PG / 5.3: Kit

### H-B 24

Artikel part article	Art.Nr. part No. N° art.	PG	M	L	L1	L2	L3	L4	B	B1	B2	B3	B4	B5	H	H1	H2	S	d
H-B 24 SDRHLH-LB 21	<b>70165200</b>	21		120	138	136,5	132	144	43			45	58	25	84	6		50	5,5
H-B 24 SDRHLH-LB 29	<b>70165400</b>	29																	
H-B 24 SDRHLH-LB M25	<b>79165200</b>		25	120	138	136,5	132	144	43			45	58	25	84	6		50	5,5
H-B 24 SDRHLH-LB M32	<b>79165400</b>		32																

Einsätze / Inserts / Inserts: 1.4: H-BE 24 / 1.5: H-EE 46 / 1.7: H-BVE 10 / 1.8: H-D 64 / 1.9: H-DD 108 / 1.10: MC 24  
Kabelverschraubung / Cable gland / Presse-étoupe: 5.1: Metr. / 5.2: PG / 5.3: Kit



# 3.2 EPIC® D A - V I N C I H - B

Sockelgehäuse / Surface mount base / Embase en saillie



PG / M

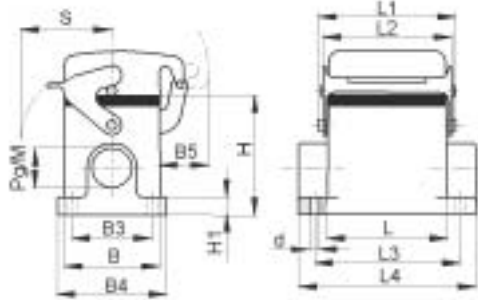

**EPIC® H-B Gehäuse: Sockelgehäuse (Schutzdeckel, 1 Kabeleingang, Längsbügel)**

*EPIC® H-B housings: surface mount base (cover, 1 cable entry, single locking lever)*

**Boîtiers EPIC® H-B: embase en saillie (couvercle, 1 entrée de câble, simple levier)**

## H-B 6

Artikel part article	Art.Nr. part No. N° art.	PG	M	L	L1	L2	L3	L4	B	B1	B2	B3	B4	B5	H	H1	H2	S	d
H-B 6 SDR 16	<b>10007000</b>	16		60	74,8	70	70	84	43			40	52	25	57	4,5		44	5,5
H-B 6 SDR M20	<b>19007000</b>		20	60	74,8	70	70	84	43			40	52	25	57	4,5		44	5,5
H-B 6 SDR M25	<b>79015600</b>		25																

Einsätze / Inserts / Inserts: 1.4: H-BE 6 / 1.5: H-EE 10 / 1.9: H-DD 24 / 1.10: MC 6  
Kabelverschraubung / Cable gland / Presse-étoupe: 5.1: Metr. / 5.2: PG / 5.3: Kit

## H-B 10

Artikel part article	Art.Nr. part No. N° art.	PG	M	L	L1	L2	L3	L4	B	B1	B2	B3	B4	B5	H	H1	H2	S	d
H-B 10 SDR-LB 16	<b>10036900</b>	16		73	91	88,5	82	94	43			40	52	25	57	4,5		50	5,5
H-B 10 SDR-LB M20	<b>19036900</b>		20	73	91	88,5	82	94	43			40	52	25	57	4,5		50	5,5
H-B 10 SDR-LB M25	<b>79064600</b>		25																

Einsätze / Inserts / Inserts: 1.4: H-BE 10 / 1.5: H-EE 18 / 1.7: H-BVE 3 / 1.9: H-DD 42 / 1.10: MC 10  
Kabelverschraubung / Cable gland / Presse-étoupe: 5.1: Metr. / 5.2: PG / 5.3: Kit

## H-B 16

Artikel part article	Art.Nr. part No. N° art.	PG	M	L	L1	L2	L3	L4	B	B1	B2	B3	B4	B5	H	H1	H2	S	d
H-B 16 SDR-LB 21	<b>10076900</b>	21		93	111	109,5	105	117	43			45	57	25	64	4,5		50	5,5
H-B 16 SDR-LB M25	<b>19076900</b>		25	93	111	109,5	105	117	43			45	57	25	64	4,5		50	5,5

Einsätze / Inserts / Inserts: 1.4: H-BE 16 / 1.5: H-EE 32 / 1.6: H-BS 6 / 1.7: H-BVE 6 / 1.8: H-D 40 / 1.9: H-DD 72 / 1.10: MC 16  
Kabelverschraubung / Cable gland / Presse-étoupe: 5.1: Metr. / 5.2: PG / 5.3: Kit

## 3.2 EPIC® D A - V I N C I H - B

Sockelgehäuse / Surface mount base / Embase en saillie



PG / M

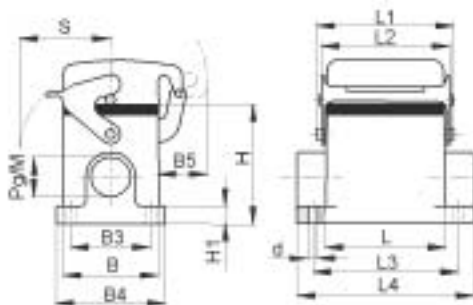

**EPIC® H-B Gehäuse: Sockelgehäuse (Schutzdeckel, 1 Kabeleingang, Längsbügel)**

**EPIC® H-B housings: surface mount base (cover, 1 cable entry, single locking lever)**

**Boîtiers EPIC® H-B: embase en saillie (couverture, 1 entrée de câble, simple levier)**

### H-B 24

Artikel part article	Art.Nr. part No. N° art.	PG	M	L	L1	L2	L3	L4	B	B1	B2	B3	B4	B5	H	H1	H2	S	d
H-B 24 SDR-LB 21	<b>10107900</b>		21	120	138	136,5	132	144	43			45	57	25	64	4,5		50	5,5
H-B 24 SDR-LB M25	<b>19107900</b>		25	120	138	136,5	132	144	43			45	57	25	64	4,5		50	5,5

Einsätze / Inserts / Inserts: 1.4: H-BE 24 / 1.5: H-EE 46 / 1.7: H-BVE 10 / 1.8: H-D 64 / 1.9: H-DD 108 / 1.10: MC 24

Kabelverschraubung / Cable gland / Presse-étoupe: 5.1: Metr. / 5.2: PG / 5.3: Kit

### H-B 48

Artikel part article	Art.Nr. part No. N° art.	PG	M	L	L1	L2	L3	L4	B	B1	B2	B3	B4	B5	H	H1	H2	S	d
H-B 48 SDR 29	<b>10167000</b>		29		132	152	139,5	111	132	90		106	120	30	100	12		105	6,5
H-B 48 SDR 36	<b>10167100</b>		36		132	152	139,5	111	132	90		106	120	30	100	12		105	6,5
H-B 48 SDR M32	<b>19167000</b>		32		132	152	139,5	111	132	90		106	120	30	100	12		105	6,5
H-B 48 SDR M 40	<b>19167100</b>		40		132	152	139,5	111	132	90		106	120	30	100	12		105	6,5

Einsätze / Inserts / Inserts: 1.4: H-BE 48 / 1.5: H-EE 92 / 1.7: 2 x H-BVE 10 / 1.8: H-D 128 / 1.9: H-DD 216 / 1.10: 2 x MC 24

Kabelverschraubung / Cable gland / Presse-étoupe: 5.1: Metr. / 5.2: PG / 5.3: Kit

## 3.2 EPIC® D A - V I N C I H - B

Sockelgehäuse / Surface mount base / Embase en saillie



PG / M

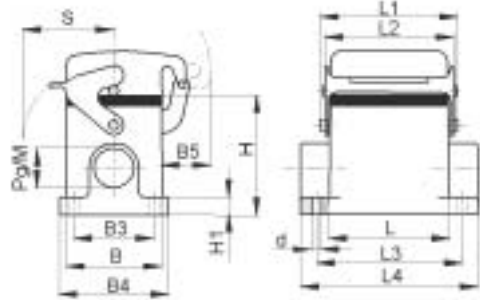

**EPIC® H-B Gehäuse: Sockelgehäuse (Schutzdeckel, 1 Kabeleingang, Längsbügel, hohe Bauform)**

**EPIC® H-B housings: surface mount base (cover, 1 cable entry, single locking lever, high version)**

**Boîtiers EPIC® H-B: embase en saillie (couvercle, 1 entrée de câble, simple levier, version haute)**

### H-B 6

Artikel part article	Art.Nr. part No. N° art.	PG	M	L	L1	L2	L3	L4	B	B1	B2	B3	B4	B5	H	H1	H2	S	d	
H-B 6 SDRH 21	<b>70015200</b>	21		60	74,8	70	70	84	43			45	58	25	74	6		44	5,5	
H-B 6 SDRH 29	<b>70015400</b>	29																		
H-B 6 SDRH M25	<b>79015200</b>		25	60	74,8	70	70	84	43			45	58	25	74	6		44	5,5	
H-B 6 SDRH M32	<b>79015400</b>		32																	

Einsätze / Inserts / Inserts: 1.4: H-BE 6 / 1.5: H-EE 10 / 1.9: H-DD 24 / 1.10: MC 6

Kabelverschraubung / Cable gland / Presse-étoupe: 5.1: Metr. / 5.2: PG / 5.3: Kit

### H-B 10

Artikel part article	Art.Nr. part No. N° art.	PG	M	L	L1	L2	L3	L4	B	B1	B2	B3	B4	B5	H	H1	H2	S	d	
H-B 10 SDRH-LB 21	<b>70064200</b>	21		73	91	88,5	82	97	43			45	58	25	74	6		50	5,5	
H-B 10 SDRH-LB 29	<b>70064400</b>	29																		
H-B 10 SDRH-LB M25	<b>79064200</b>		25	73	91	88,5	82	97	43			45	58	25	74	6		50	5,5	
H-B 10 SDRH-LB M32	<b>79064400</b>		32																	

Einsätze / Inserts / Inserts: 1.4: H-BE 10 / 1.5: H-EE 18 / 1.7: H-BVE 3 / 1.9: H-DD 42 / 1.10: MC 10

Kabelverschraubung / Cable gland / Presse-étoupe: 5.1: Metr. / 5.2: PG / 5.3: Kit

## 3.2 EPIC® D A - V I N C I H - B

Sockelgehäuse / Surface mount base / Embase en saillie



PG / M

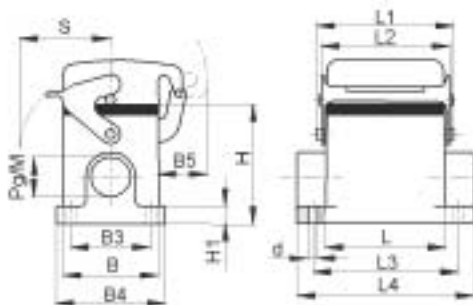

**EPIC® H-B Gehäuse: Sockelgehäuse (Schutzdeckel, 1 Kabeleingang, Längsbügel, hohe Bauform)**

**EPIC® H-B housings: surface mount base (cover, 1 cable entry, single locking lever, high version)**

**Boîtiers EPIC® H-B: embase en saillie (couverture, 1 entrée de câble, simple levier, version haute)**

### H-B 16

Artikel part article	Art.Nr. part No. N° art.	PG	M	L	L1	L2	L3	L4	B	B1	B2	B3	B4	B5	H	H1	H2	S	d
H-B 16 SDRH-LB 21	<b>70114200</b>	21		93,3	111	109,5	105	117	43			45	58	25	84	6		50	5,5
H-B 16 SDRH-LB 29	<b>70114400</b>	29																	
H-B 16 SDRH-LB M25	<b>79114200</b>		25	93,3	111	109,5	105	117	43			45	58	25	84	6		50	5,5
H-B 16 SDRH-LB M32	<b>79114400</b>		32																

Einsätze / Inserts / Inserts: 1.4: H-BE 16 / 1.5: H-EE 32 / 1.6: H-BS 6 / 1.7: H-BVE 6 / 1.8: H-D 40 / 1.9: H-DD 72 / 1.10: MC 16  
Kabelverschraubung / Cable gland / Presse-étoupe: 5.1: Metr. / 5.2: PG / 5.3: Kit

### H-B 24

Artikel part article	Art.Nr. part No. N° art.	PG	M	L	L1	L2	L3	L4	B	B1	B2	B3	B4	B5	H	H1	H2	S	d
H-B 24 SDRH-LB 21	<b>70164200</b>	21		120	138	136,5	132	144	43			45	58	25	84	6		50	5,5
H-B 24 SDRH-LB 29	<b>70164400</b>	29																	
H-B 24 SDRH-LB M25	<b>79164200</b>		25	120	138	136,5	132	144	43			45	58	25	84	6		50	5,5
H-B 24 SDRH-LB M32	<b>79164400</b>		32																

Einsätze / Inserts / Inserts: 1.4: H-BE 24 / 1.5: H-EE 46 / 1.7: H-BVE 10 / 1.8: H-D 64 / 1.9: H-DD 108 / 1.10: MC 24  
Kabelverschraubung / Cable gland / Presse-étoupe: 5.1: Metr. / 5.2: PG / 5.3: Kit

# 3.2 EPIC® D A - V I N C I H - B

Sockelgehäuse / Surface mount base / Embase en saillie

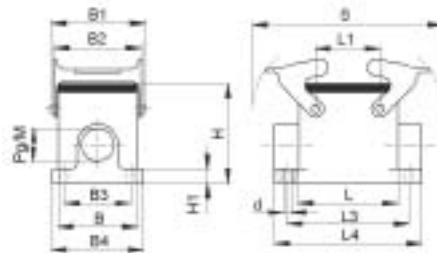

PG / M

**EPIC® H-B Gehäuse: Sockelgehäuse (2 Kabeleingänge, Querbügel)**

*EPIC® H-B housings: surface mount base (2 cable entries, double locking lever)*

**Boîtiers EPIC® H-B: embase en saillie (2 entrées de câble, double levier)**

## H-B 10

Artikel part article	Art.Nr. part No. N° art.	PG	M	L	L1	L2	L3	L4	B	B1	B2	B3	B4	B5	H	H1	H2	S	d
H-B 10 SGRL 16	<b>10035000</b>		16	73	27		82	94	43	57,8	53	40	52		57	4,5		116	5,5
H-B 10 SGRL M20	<b>19035000</b>		20	73	27		82	94	43	57,8	53	40	52		57	4,5		116	5,5
H-B 10 SGRL M25	<b>19035100</b>		25																

Einsätze / Inserts / Inserts: 1.4: H-BE 10 / 1.5: H-EE 18 / 1.7: H-BVE 3 / 1.9: H-DD 42 / 1.10: MC 10

Deckel / Cover / Couvercle: 6.1: H-B 10

Kabelverschraubung / Cable gland / Presse-étoupe: 5.1: Metr. / 5.2: PG / 5.3: Kit

## H-B 16

Artikel part article	Art.Nr. part No. N° art.	PG	M	L	L1	L2	L3	L4	B	B1	B2	B3	B4	B5	H	H1	H2	S	d
H-B 16 SGRL 21	<b>10075000</b>		21	93	47,5		105	117	43	57,8	53	45	57		64	4,5		136,5	5,5
H-B 16 SGRL M25	<b>19075000</b>		25	93	47,5		105	117	43	57,8	53	45	57		64	4,5		136,5	5,5

Einsätze / Inserts / Inserts: 1.4: H-BE 16 / 1.5: H-EE 32 / 1.6: H-BS 6 / 1.7: H-BVE 6 / 1.8: H-D 40 / 1.9: H-DD 72 / 1.10: MC 16

Deckel / Cover / Couvercle: 6.1: H-B 16

Kabelverschraubung / Cable gland / Presse-étoupe: 5.1: Metr. / 5.2: PG / 5.3: Kit

## H-B 24

Artikel part article	Art.Nr. part No. N° art.	PG	M	L	L1	L2	L3	L4	B	B1	B2	B3	B4	B5	H	H1	H2	S	d
H-B 24 SGRL 21	<b>10105000</b>		21	120	74		132	144	43	57,8	53	45	57		64	4,5		163	5,5
H-B 24 SGRL M25	<b>19105000</b>		25	120	74		132	144	43	57,8	53	45	57		64	4,5		163	5,5

Einsätze / Inserts / Inserts: 1.4: H-BE 24 / 1.5: H-EE 46 / 1.7: H-BVE 10 / 1.8: H-D 64 / 1.9: H-DD 108 / 1.10: MC 24

Kabelverschraubung / Cable gland / Presse-étoupe: 5.1: Metr. / 5.2: PG / 5.3: Kit

## H-B 32

Artikel part article	Art.Nr. part No. N° art.	PG	M	L	L1	L2	L3	L4	B	B1	B2	B3	B4	B5	H	H1	H2	S	d
H-B 32 SGRL 29	<b>10138000</b>		29																
H-B 32 SGRL M32	<b>19138000</b>		32	93,5	64,5		112	124,5	79	93,8	87,8	67	81		72	5		136,5	5,5
H-B 32 SGRL M40	<b>19145400</b>		40																

Einsätze / Inserts / Inserts: 1.4: H-BE 32 / 1.5: H-EE 64 / 1.6: H-BS 12 / 1.8: H-D 80 / 1.9: H-DD 144 / 1.10: 2 x MC 16

Kabelverschraubung / Cable gland / Presse-étoupe: 5.1: Metr. / 5.2: PG / 5.3: Kit

# 3.2 EPIC® D A - V I N C I H - B

Sockelgehäuse / Surface mount base / Embase en saillie

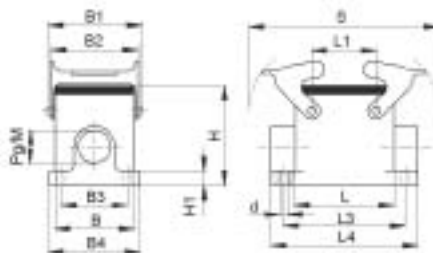

**PG / M**

**EPIC® H-B Gehäuse: Sockelgehäuse (2 Kabeleingänge, Querbügel, hohe Bauform)**

**EPIC® H-B housings: surface mount base (2 cable entries, double locking lever, high version)**

**Boîtiers EPIC® H-B: embase en saillie (2 entrées de câble, double levier, version haute)**

## H-B 10

Artikel part article	Art.Nr. part No. N° art.	PG	M	L	L1	L2	L3	L4	B	B1	B2	B3	B4	B5	H	H1	H2	S	d
H-B 10 SGR LH 21	<b>70036200</b>	21		73	27		82	97	43	57,8	53	45	58		74	6		116	5,5
H-B 10 SGR LH 29	<b>70036400</b>	29																	
H-B 10 SGR LH M25	<b>79036200</b>		25	73	27		82	97	43	57,8	53	45	58		74	6		116	5,5
H-B 10 SGR LH M32	<b>79036400</b>		32																

Einsätze / Inserts / Inserts: 1.4: H-BE 10 / 1.5: H-EE 18 / 1.7: H-BVE 3 / 1.9: H-DD 42 / 1.10: MC 10

Deckel / Cover / Couvercle: 6.1: H-B 10

Kabelverschraubung / Cable gland / Presse-étoupe: 5.1: Metr. / 5.2: PG / 5.3: Kit

## H-B 16

Artikel part article	Art.Nr. part No. N° art.	PG	M	L	L1	L2	L3	L4	B	B1	B2	B3	B4	B5	H	H1	H2	S	d
H-B 16 SGR LH 21	<b>70086200</b>	21		93,3	47,5		105	117	43	57,8	53	45	58		84	6		136,5	5,5
H-B 16 SGR LH 29	<b>70086400</b>	29																	
H-B 16 SGR LH M25	<b>79086200</b>		25	93,3	47,5		105	117	43	57,8	53	45	58		84	6		136,5	5,5
H-B 16 SGR LH M32	<b>79086400</b>		32																

Einsätze / Inserts / Inserts: 1.4: H-BE 16 / 1.5: H-EE 32 / 1.6: H-BS 6 / 1.7: H-BVE 6 / 1.8: H-D 40 / 1.9: H-DD 72 / 1.10: MC 16

Deckel / Cover / Couvercle: 6.1: H-B 16

Kabelverschraubung / Cable gland / Presse-étoupe: 5.1: Metr. / 5.2: PG / 5.3: Kit

## H-B 24

Artikel part article	Art.Nr. part No. N° art.	PG	M	L	L1	L2	L3	L4	B	B1	B2	B3	B4	B5	H	H1	H2	S	d
H-B 24 SGR LH 21	<b>70136200</b>	21		120	74		132	144	43	57,8	53	45	58		84	6		163	5,5
H-B 24 SGR LH 29	<b>70136400</b>	29																	
H-B 24 SGR LH M25	<b>79136200</b>		25	120	74		132	144	43	57,8	53	45	58		84	6		163	5,5
H-B 24 SGR LH M32	<b>79136400</b>		32																

Einsätze / Inserts / Inserts: 1.4: H-BE 24 / 1.5: H-EE 46 / 1.7: H-BVE 10 / 1.8: H-D 64 / 1.9: H-DD 108 / 1.10: MC 24

Deckel / Cover / Couvercle: 6.1: H-B 24

Kabelverschraubung / Cable gland / Presse-étoupe: 5.1: Metr. / 5.2: PG / 5.3: Kit

# 3.2 EPIC® D A - V I N C I H - B

Sockelgehäuse / Surface mount base / Embase en saillie

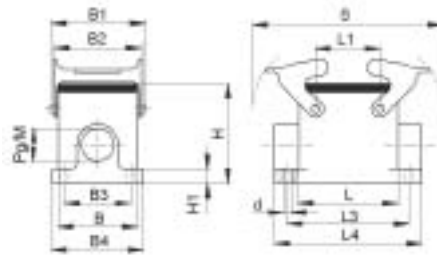

PG / M

**EPIC® H-B Gehäuse: Sockelgehäuse (1 Kabeleingang, Querbügel)**  
**EPIC® H-B housings: surface mount base (1 cable entry, double locking lever)**  
**Boîtiers EPIC® H-B: embase en saillie (1 entrée de câble, double levier)**

## H-B 10

Artikel part article	Art.Nr. part No. N° art.	PG	M	L	L1	L2	L3	L4	B	B1	B2	B3	B4	B5	H	H1	H2	S	d
H-B 10 SGR 16	<b>10034000</b>	16		73	27		82	94	43	57,8	53	40	52		57	4,5		116	5,5
H-B 10 SGR M20	<b>19034000</b>		20	73	27		82	94	43	57,8	53	40	52		57	4,5		116	5,5
H-B 10 SGR M25	<b>19034100</b>		25																

Einsätze / Inserts / Inserts: 1.4: H-BE 10 / 1.5: H-EE 18 / 1.7: H-BVE 3 / 1.9: H-DD 42 / 1.10: MC 10

Deckel / Cover / Couvercle: 6.1: H-B 10

Kabelverschraubung / Cable gland / Presse-étoupe: 5.1: Metr. / 5.2: PG / 5.3: Kit

## H-B 16

Artikel part article	Art.Nr. part No. N° art.	PG	M	L	L1	L2	L3	L4	B	B1	B2	B3	B4	B5	H	H1	H2	S	d
H-B 16 SGR 21	<b>10074000</b>	21		93	47,5		105	117	43	57,8	53	45	57		64	4,5		136,5	5,5
H-B 16 SGR M25	<b>19074000</b>		25	93	47,5		105	117	43	57,8	53	45	57		64	4,5		136,5	5,5

Einsätze / Inserts / Inserts: 1.4: H-BE 16 / 1.5: H-EE 32 / 1.6: H-BS 6 / 1.7: H-BVE 6 / 1.8: H-D 40 / 1.9: H-DD 72 / 1.10: MC 16

Deckel / Cover / Couvercle: 6.1: H-B 16

Kabelverschraubung / Cable gland / Presse-étoupe: 5.1: Metr. / 5.2: PG / 5.3: Kit

## H-B 24

Artikel part article	Art.Nr. part No. N° art.	PG	M	L	L1	L2	L3	L4	B	B1	B2	B3	B4	B5	H	H1	H2	S	d
H-B 24 SGR 21	<b>10104000</b>	21		120	74		132	144	43	57,8	53	45	57		64	4,5		163	5,5
H-B 24 SGR M25	<b>19104000</b>		25	120	74		132	144	43	57,8	53	45	57		64	4,5		163	5,5

Einsätze / Inserts / Inserts: 1.4: H-BE 24 / 1.5: H-EE 46 / 1.7: H-BVE 10 / 1.8: H-D 64 / 1.9: H-DD 108 / 1.10: MC 24

Deckel / Cover / Couvercle: 6.1: H-B 24

Kabelverschraubung / Cable gland / Presse-étoupe: 5.1: Metr. / 5.2: PG / 5.3: Kit

## H-B 32

Artikel part article	Art.Nr. part No. N° art.	PG	M	L	L1	L2	L3	L4	B	B1	B2	B3	B4	B5	H	H1	H2	S	d
H-B 32 SGR 29	<b>10137000</b>	29																	
H-B 32 SGR M32	<b>19137000</b>		32	93,5	64,5		112	124,5	79	93,8	87,8	67	81		72	5		136,5	5,5
H-B 32 SGR M40	<b>19146400</b>		40																

Einsätze / Inserts / Inserts: 1.4: H-BE 32 / 1.5: H-EE 64 / 1.6: H-BS 12 / 1.8: H-D 80 / 1.9: H-DD 144 / 1.10: 2 x MC 16

Kabelverschraubung / Cable gland / Presse-étoupe: 5.1: Metr. / 5.2: PG / 5.3: Kit

# 3.2 EPIC® D A - V I N C I H - B

Sockelgehäuse / Surface mount base / Embase en saillie

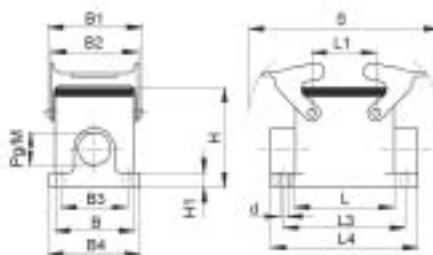

**PG / M**

**EPIC® H-B Gehäuse: Sockelgehäuse (1 Kabeleingang, Querbügel, hohe Bauform)**

**EPIC® H-B housings: surface mount base (1 cable entry, double locking lever, high version)**

**Boîtiers EPIC® H-B: embase en saillie (1 entrée de câble, double levier, version haute)**

## H-B 10

Artikel part article	Art.Nr. part No. N° art.	PG	M	L	L1	L2	L3	L4	B	B1	B2	B3	B4	B5	H	H1	H2	S	d
H-B 10 SGRH 21	<b>70035200</b>	21		73	27		82	97	43	57,8	53	45	58		74	6		116	5,5
H-B 10 SGRH 29	<b>70035400</b>	29																	
H-B 10 SGRH M25	<b>79035200</b>		25	73	27		82	97	43	57,8	53	45	58		74	6		116	5,5
H-B 10 SGRH M32	<b>79035400</b>		32																

Einsätze / Inserts / Inserts: 1.4: H-BE 10 / 1.5: H-EE 18 / 1.7: H-BVE 3 / 1.9: H-DD 42 / 1.10: MC 10

Deckel / Cover / Couvercle: 6.1: H-B 10

Kabelverschraubung / Cable gland / Presse-étoupe: 5.1: Metr. / 5.2: PG / 5.3: Kit

## H-B 16

Artikel part article	Art.Nr. part No. N° art.	PG	M	L	L1	L2	L3	L4	B	B1	B2	B3	B4	B5	H	H1	H2	S	d
H-B 16 SGRH 21	<b>70085200</b>	21		93,3	47,5		105	117	43	57,8	53	45	58		84	6		136,5	5,5
H-B 16 SGRH 29	<b>70085400</b>	29																	
H-B 16 SGRH M25	<b>79085200</b>		25	93,3	47,5		105	117	43	57,8	53	45	58		84	6		136,5	5,5
H-B 16 SGRHM32	<b>79085400</b>		32																

Einsätze / Inserts / Inserts: 1.4: H-BE 16 / 1.5: H-EE 32 / 1.6: H-BS 6 / 1.7: H-BVE 6 / 1.8: H-D 40 / 1.9: H-DD 72 / 1.10: MC 16

Deckel / Cover / Couvercle: 6.1: H-B 16

Kabelverschraubung / Cable gland / Presse-étoupe: 5.1: Metr. / 5.2: PG / 5.3: Kit

## H-B 24

Artikel part article	Art.Nr. part No. N° art.	PG	M	L	L1	L2	L3	L4	B	B1	B2	B3	B4	B5	H	H1	H2	S	d
H-B 24 SGRH 21	<b>70135200</b>	21		120	74		132	144	43	57,8	53	45	58		84	6		163	5,5
H-B 24 SGRH 29	<b>70135400</b>	29																	
H-B 24 SGRH M25	<b>79135200</b>		25	120	74		132	144	43	57,8	53	45	58		84	6		163	5,5
H-B 24 SGRH M32	<b>79135400</b>		32																

Einsätze / Inserts / Inserts: 1.4: H-BE 24 / 1.5: H-EE 46 / 1.7: H-BVE 10 / 1.8: H-D 64 / 1.9: H-DD 108 / 1.10: MC 24

Deckel / Cover / Couvercle: 6.1: H-B 24

Kabelverschraubung / Cable gland / Presse-étoupe: 5.1: Metr. / 5.2: PG / 5.3: Kit



## 3.2 EPIC® D A - V I N C I H - B

Sockelgehäuse / Surface mount base / Embase en saillie

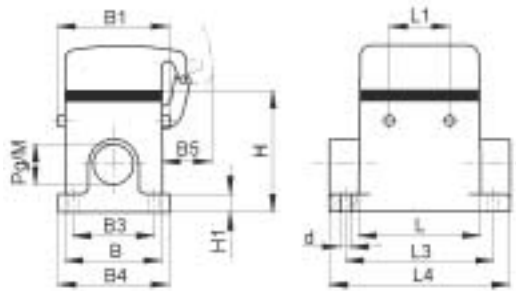

PG / M

**EPIC® H-B Gehäuse: Sockelgehäuse (Schutzdeckel, 2 Kabeleingänge, Bolzen für Querbügel)**  
**EPIC® H-B housings: surface mount base (cover, 2 cable entries, bolts for double locking lever)**  
**Boîtiers EPIC® H-B: embase en saillie (couvercle, 2 entrées de câble, ergots pour double levier)**

### H-B 10

Artikel part article	Art.Nr. part No. N° art.	PG	M	L	L1	L2	L3	L4	B	B1	B2	B3	B4	B5	H	H1	H2	S	d
H-B 10 SDRL-BO 16	<b>10038000</b>		16	73	27		82	94	43	57,8		40	52	25	57	4,5			5,5
H-B 10 SDRL-BO M20	<b>19038000</b>		20	73	27		82	94	43	57,8		40	52	25	57	4,5			5,5
H-B 10 SDRL-BO M25	<b>79046600</b>		25																

Einsätze / Inserts / Inserts: 1.4: H-BE 10 / 1.5: H-EE 18 / 1.7: H-BVE 3 / 1.9: H-DD 42 / 1.10: MC 10  
 Kabelverschraubung / Cable gland / Presse-étoupe: 5.1: Metr. / 5.2: PG / 5.3: Kit

### H-B 16

Artikel part article	Art.Nr. part No. N° art.	PG	M	L	L1	L2	L3	L4	B	B1	B2	B3	B4	B5	H	H1	H2	S	d
H-B 16 SDRL-BO 21	<b>70096000</b>		21	93	47,5		105	117	43	57,8		45	57	25	64	4,5			5,5
H-B 16 SDRL-BO M25	<b>79096000</b>		25	93	47,5		105	117	43	57,8		45	57	25	64	4,5			5,5

Einsätze / Inserts / Inserts: 1.4: H-BE 16 / 1.5: H-EE 32 / 1.6: H-BS 6 / 1.7: H-BVE 6 / 1.8: H-D 40 / 1.9: H-DD 72 / 1.10: MC 16  
 Kabelverschraubung / Cable gland / Presse-étoupe: 5.1: Metr. / 5.2: PG / 5.3: Kit

### H-B 24

Artikel part article	Art.Nr. part No. N° art.	PG	M	L	L1	L2	L3	L4	B	B1	B2	B3	B4	B5	H	H1	H2	S	d
H-B 24 SDRL-BO 21	<b>10109000</b>		21	120	74		132	144	43	57,8		45	57	25	64	4,5			5,5
H-B 24 SDRL-BO M25	<b>19109000</b>		25	120	74		132	144	43	57,8		45	57	25	64	4,5			5,5

Einsätze / Inserts / Inserts: 1.4: H-BE 24 / 1.5: H-EE 46 / 1.7: H-BVE 10 / 1.8: H-D 64 / 1.9: H-DD 108 / 1.10: MC 24  
 Kabelverschraubung / Cable gland / Presse-étoupe: 5.1: Metr. / 5.2: PG / 5.3: Kit

## 3.2 EPIC® D A - V I N C I H - B

Sockelgehäuse / Surface mount base / Embase en saillie

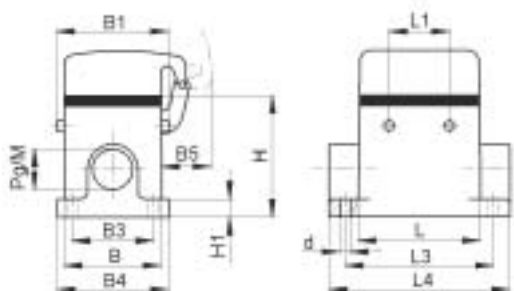

PG / M

EPIC® H-B Gehäuse: Sockelgehäuse (Schutzdeckel, 2 Kabeleingänge, Bolzen für Querbügel, hohe Bauform)

EPIC® H-B housings: surface mount base (cover, 2 cable entries, bolts for double locking lever, high version)

Boîtiers EPIC® H-B: embase en saillie (covercle, 2 entrées de câble, ergots pour double levier, version haute)

### H-B 10

Artikel part article	Art.Nr. part No. N° art.	PG	M	L	L1	L2	L3	L4	B	B1	B2	B3	B4	B5	H	H1	H2	S	d	
H-B 10 SDR LH-BO 21	<b>70046200</b>	21		73	27		82	97	43	57,8		45	58	25	74	6			5,5	
H-B 10 SDR LH-BO 29	<b>70046400</b>	29																		
H-B 10 SDR LH-BO M25	<b>79046200</b>		25	73	27		82	97	43	57,8		45	58	25	74	6			5,5	
H-B 10 SDR LH-BO M32	<b>79046400</b>		32																	

Einsätze / Inserts / Inserts: 1.4: H-BE 10 / 1.5: H-EE 18 / 1.7: H-BVE 3 / 1.9: H-DD 42 / 1.10: MC 10

Kabelverschraubung / Cable gland / Presse-étoupe: 5.1: Metr. / 5.2: PG / 5.3: Kit

### H-B 16

Artikel part article	Art.Nr. part No. N° art.	PG	M	L	L1	L2	L3	L4	B	B1	B2	B3	B4	B5	H	H1	H2	S	d	
H-B 16 SDR LH-BO 21	<b>70096200</b>	21		93,3	47,5		105	117	43	57,8		45	58	25	84	6			5,5	
H-B 16 SDR LH-BO 29	<b>70096400</b>	29																		
H-B 16 SDR LH-BO M25	<b>79096200</b>		25	93,3	47,5		105	117	43	57,8		45	58	25	84	6			5,5	
H-B 16 SDR LH-BO M32	<b>79096400</b>		32																	

Einsätze / Inserts / Inserts: 1.4: H-BE 16 / 1.5: H-EE 32 / 1.6: H-BS 6 / 1.7: H-BVE 6 / 1.8: H-D 40 / 1.9: H-DD 72 / 1.10: MC 16

Kabelverschraubung / Cable gland / Presse-étoupe: 5.1: Metr. / 5.2: PG / 5.3: Kit

### H-B 24

Artikel part article	Art.Nr. part No. N° art.	PG	M	L	L1	L2	L3	L4	B	B1	B2	B3	B4	B5	H	H1	H2	S	d	
H-B 24 SDR LH-BO 21	<b>70146200</b>	21		120	74		132	144	43	57,8		45	58	25	84	6			5,5	
H-B 24 SDR LH-BO 29	<b>70146400</b>	29																		
H-B 24 SDR LH-BO M25	<b>79146200</b>		25	120	74		132	144	43	57,8		45	58	25	84	6			5,5	
H-B 24 SDR LH-BO M32	<b>79146400</b>		32																	

Einsätze / Inserts / Inserts: 1.4: H-BE 24 / 1.5: H-EE 46 / 1.7: H-BVE 10 / 1.8: H-D 64 / 1.9: H-DD 108 / 1.10: MC 24

Kabelverschraubung / Cable gland / Presse-étoupe: 5.1: Metr. / 5.2: PG / 5.3: Kit

# 3.2 EPIC® D A - V I N C I H - B

Sockelgehäuse / Surface mount base / Embase en saillie

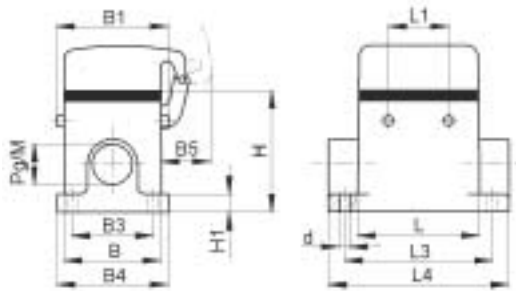

PG / M

**EPIC® H-B Gehäuse: Sockelgehäuse (Schutzdeckel, 1 Kabeleingang, Bolzen für Querbügel)**  
**EPIC® H-B housings: surface mount base (cover, 1 cable entry, bolts for double locking lever)**  
**Boîtiers EPIC® H-B: embase en saillie (couvercle, 1 entrée de câble, ergots pour double levier)**

## H-B 10

Artikel part article	Art.Nr. part No. N° art.	PG	M	L	L1	L2	L3	L4	B	B1	B2	B3	B4	B5	H	H1	H2	S	d
H-B 10 SDR-BO 16	<b>10036000</b>	16		73	27		82	94	43	57,8		40	52	25	57	4,5			5,5
H-B 10 SDR-BO M20	<b>19036000</b>		20	73	27		82	94	43	57,8		40	52	25	57	4,5			5,5
H-B 10 SDR-BO M25	<b>19036100</b>		25																

Einsätze / Inserts / Inserts: 1.4: H-BE 10 / 1.5: H-EE 18 / 1.7: H-BVE 3 / 1.9: H-DD 42 / 1.10: MC 10  
 Kabelverschraubung / Cable gland / Presse-étoupe: 5.1: Metr. / 5.2: PG / 5.3: Kit

## H-B 16

Artikel part article	Art.Nr. part No. N° art.	PG	M	L	L1	L2	L3	L4	B	B1	B2	B3	B4	B5	H	H1	H2	S	d
H-B 16 SDR-BO 21	<b>10076000</b>	21		93	47,5		105	117	43	57,8		45	57	25	64	4,5			5,5
H-B 16 SDR-BO M25	<b>19076000</b>		25	93	47,5		105	117	43	57,8		45	57	25	64	4,5			5,5

Einsätze / Inserts / Inserts: 1.4: H-BE 16 / 1.5: H-EE 32 / 1.6: H-BS 6 / 1.7: H-BVE 6 / 1.8: H-D 40 / 1.9: H-DD 72 / 1.10: MC 16  
 Kabelverschraubung / Cable gland / Presse-étoupe: 5.1: Metr. / 5.2: PG / 5.3: Kit

## H-B 24

Artikel part article	Art.Nr. part No. N° art.	PG	M	L	L1	L2	L3	L4	B	B1	B2	B3	B4	B5	H	H1	H2	S	d
H-B 24 SDR-BO 21	<b>10107000</b>	21		120	74		132	144	43	57,8		45	57	25	64	4,5			5,5
H-B 24 SDR-BO M25	<b>19107000</b>		25	120	74		132	144	43	57,8		45	57	25	64	4,5			5,5

Einsätze / Inserts / Inserts: 1.4: H-BE 24 / 1.5: H-EE 46 / 1.7: H-BVE 10 / 1.8: H-D 64 / 1.9: H-DD 108 / 1.10: MC 24  
 Kabelverschraubung / Cable gland / Presse-étoupe: 5.1: Metr. / 5.2: PG / 5.3: Kit

## 3.2 EPIC® D A - V I N C I H - B

Sockelgehäuse / Surface mount base / Embase en saillie



PG / M

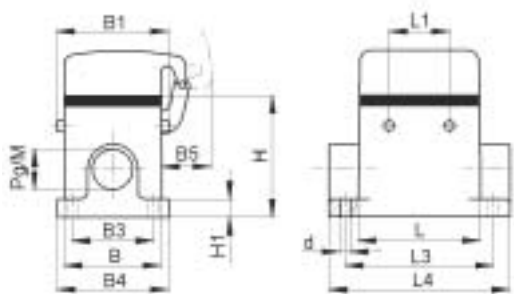

**EPIC® H-B Gehäuse: Sockelgehäuse (Schutzdeckel, 1 Kabeleingang, Bolzen für Querbügel, hohe Bauform)**  
**EPIC® H-B housings: surface mount base (cover, 1 cable entry, bolts for double locking lever, high version)**  
**Boîtiers EPIC® H-B: embase en saillie (covercle, 1 entrée de câble, ergots pour double levier, version haute)**

### H-B 10

Artikel part article	Art.Nr. part No. N° art.	PG	M	L	L1	L2	L3	L4	B	B1	B2	B3	B4	B5	H	H1	H2	S	d
H-B 10 SDRH-BO 21	<b>70045200</b>	21		73	27		82	97	43	57,8		45	58	25	74	6			5,5
H-B 10 SDRH-BO 29	<b>70045400</b>	29																	
H-B 10 SDRH-BO M25	<b>79045200</b>		25	73	27		82	97	43	57,8		45	58	25	74	6			5,5
H-B 10 SDRH-BO M32	<b>79045400</b>		32																

Einsätze / Inserts / Inserts: 1.4: H-BE 10 / 1.5: H-EE 18 / 1.7: H-BVE 3 / 1.9: H-DD 42 / 1.10: MC 10  
 Kabelverschraubung / Cable gland / Presse-étoupe: 5.1: Metr. / 5.2: PG / 5.3: Kit

### H-B 16

Artikel part article	Art.Nr. part No. N° art.	PG	M	L	L1	L2	L3	L4	B	B1	B2	B3	B4	B5	H	H1	H2	S	d
H-B 16 SDRH-BO 21	<b>70095200</b>	21		93,3	47,5		105	117	43	57,8		45	58	25	84	6			5,5
H-B 16 SDRH-BO 29	<b>70095400</b>	29																	
H-B 16 SDRH-BO M25	<b>79095200</b>		25	93,3	47,5		105	117	43	57,8		45	58	25	84	6			5,5
H-B 16 SDRH-BO M32	<b>79095400</b>		32																

Einsätze / Inserts / Inserts: 1.4: H-BE 16 / 1.5: H-EE 32 / 1.6: H-BS 6 / 1.7: H-BVE 6 / 1.8: H-D 40 / 1.9: H-DD 72 / 1.10: MC 16  
 Kabelverschraubung / Cable gland / Presse-étoupe: 5.1: Metr. / 5.2: PG / 5.3: Kit

### H-B 24

Artikel part article	Art.Nr. part No. N° art.	PG	M	L	L1	L2	L3	L4	B	B1	B2	B3	B4	B5	H	H1	H2	S	d
H-B 24 SDRH-BO 21	<b>70145200</b>	21		120	74		132	144	43	57,8		45	58	25	84	6			5,5
H-B 24 SDRH-BO 29	<b>70145400</b>	29																	
H-B 24 SDRH-BO M25	<b>79145200</b>		25	120	74		132	144	43	57,8		45	58	25	84	6			5,5
H-B 24 SDRH-BO M32	<b>79145400</b>		32																

Einsätze / Inserts / Inserts: 1.4: H-BE 24 / 1.5: H-EE 46 / 1.7: H-BVE 10 / 1.8: H-D 64 / 1.9: H-DD 108 / 1.10: MC 24  
 Kabelverschraubung / Cable gland / Presse-étoupe: 5.1: Metr. / 5.2: PG / 5.3: Kit

# 3.2 EPIC® D A - V I N C I H - B

Kupplungsgehäuse / Cable coupler hood / Capot prolongateur



PG



M

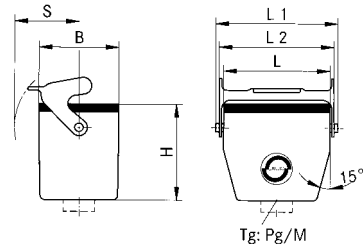

**EPIC® H-B Gehäuse: Kupplungsgehäuse (Kabeleingang gerade, Längsbügel)**

*EPIC® H-B housings: cable coupler hood (top entry, single locking lever)*

*Boîtiers EPIC® H-B: capot prolongateur (sortie verticale, simple levier)*

## H-B 6

Artikel part article	Art.Nr. part No. N° art.	PG	M	ZW	L	L1	L2	L3	L4	B	B1	B2	B3	B4	B5	H	H1	H2	S	d
H-B 6 TBF 13,5	<b>10014000</b>	13,5		●	60	74,8	70			43						54,8			44	
H-B 6 TBF 16	<b>10024000</b>	16		●																
H-B 6 TBF M20	<b>19014000</b>		20		60	74,8	70			43						54,8			44	
H-B 6 TBF M25	<b>19024000</b>		25																	

Einsätze / Inserts / Inserts: 1.4: H-BE 6 / 1.5: H-EE 10 / 1.9: H-DD 24 / 1.10: MC 6

Deckel / Cover / Couvercle: 6.1: H-B 6

Kabelverschraubung / Cable gland / Presse-étoupe: 5.1: Metr. / 5.2: PG / 5.3: Kit

## H-B 10

Artikel part article	Art.Nr. part No. N° art.	PG	M	ZW	L	L1	L2	L3	L4	B	B1	B2	B3	B4	B5	H	H1	H2	S	d
H-B 10 TBF-LB 16	<b>10046900</b>	16		●	73	91	88,5			43						54,8			50	
H-B 10 TBF-LB 21	<b>70042200</b>	21		●																
H-B 10 TBF-LB M20	<b>19046900</b>		20		73	91	88,5			43						54,8			50	
H-B 10 TBF-LB M25	<b>79042200</b>		25																	

Einsätze / Inserts / Inserts: 1.4: H-BE 10 / 1.5: H-EE 18 / 1.7: H-BVE 3 / 1.9: H-DD 42 / 1.10: MC 10

Kabelverschraubung / Cable gland / Presse-étoupe: 5.1: Metr. / 5.2: PG / 5.3: Kit

# 3.2 EPIC® D A - V I N C I H - B

Kupplungsgehäuse / Cable coupler hood / Capot prolongateur



PG



M

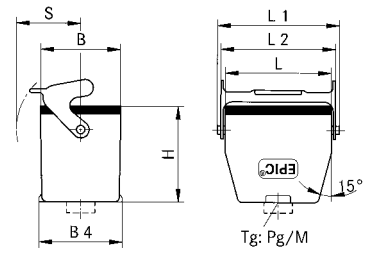

**EPIC® H-B Gehäuse: Kupplungsgehäuse (Kabeleingang gerade, Längsbügel)**

*EPIC® H-B housings: cable coupler hood (top entry, single locking lever)*

*Boîtiers EPIC® H-B: capot prolongateur (sortie verticale, simple levier)*

## H-B 16

Artikel <i>part article</i>	Art.Nr. <i>part No. N° art.</i>	PG	M	ZW	L	L1	L2	L3	L4	B	B1	B2	B3	B4	B5	H	H1	H2	S	d
H-B 16 TBF-LB 21	<b>10086900</b>	21		●	93,3	111	109,5			43						63,5			50	
H-B 16 TBF-LB M25	<b>19086900</b>		25		93,3	111	109,5			43						63,5			50	

Einsätze / Inserts / Inserts: 1.4: H-BE 16 / 1.5: H-EE 32 / 1.6: H-BS 6 / 1.7: H-BVE 6 / 1.8: H-D 40 / 1.9: H-DD 72 / 1.10: MC 16  
Kabelverschraubung / Cable gland / Presse-étoupe: 5.1: Metr. / 5.2: PG / 5.3: Kit

## H-B 24

Artikel <i>part article</i>	Art.Nr. <i>part No. N° art.</i>	PG	M	ZW	L	L1	L2	L3	L4	B	B1	B2	B3	B4	B5	H	H1	H2	S	d
H-B 24 TBF-LB 21	<b>10127900</b>	21		●	120	138	136,5			43						63,8			50	
H-B 24 TBF-LB 29	<b>10117900</b>	29		●	120	138	136,5			43						63,8			50	
H-B 24 TBF-LB M25	<b>19127900</b>		25		120	138	136,5			43						63,8			50	
H-B 24 TBF-LB M32	<b>19117900</b>		32		120	138	136,5			43						63,8			50	

Einsätze / Inserts / Inserts: 1.4: H-BE 24 / 1.5: H-EE 46 / 1.7: H-BVE 10 / 1.8: H-D 64 / 1.9: H-DD 108 / 1.10: MC 24  
Kabelverschraubung / Cable gland / Presse-étoupe: 5.1: Metr. / 5.2: PG / 5.3: Kit

# 3.2 EPIC® D A - V I N C I H - B

Kupplungsgehäuse / Cable coupler hood / Capot prolongateur



PG



M

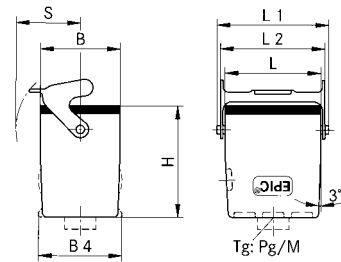

**EPIC® H-B Gehäuse: Kupplungsgehäuse (Kabeleingang gerade, Längsbügel, hohe Bauform)**

*EPIC® H-B housings: cable coupler hood (top entry, single locking lever, high version)*

*Boîtiers EPIC® H-B: capot prolongateur (sortie verticale, simple levier, version haute)*

## H-B 6

Artikel part article	Art.Nr. part No. N° art.	PG	M	ZW	L	L1	L2	L3	L4	B	B1	B2	B3	B4	B5	H	H1	H2	S	d
H-B 6 TBFH 21	<b>70010200</b>	21		●	60	74,8	70			43						74,8			44	
H-B 6 TBFH 29	<b>70010400</b>	29		●																
H-B 6 TBFH M25	<b>79010200</b>		25		60	74,8	70			43						74,8			44	
H-B 6 TBFH M32	<b>79010400</b>		32																	

Einsätze / Inserts / Inserts: 1.4: H-BE 6 / 1.5: H-EE 10 / 1.9: H-DD 24 / 1.10: MC 6

Deckel / Cover / Couvercle: 6.1: H-B 6

Kabelverschraubung / Cable gland / Presse-étoupe: 5.1: Metr. / 5.2: PG / 5.3: Kit

## H-B 10

Artikel part article	Art.Nr. part No. N° art.	PG	M	ZW	L	L1	L2	L3	L4	B	B1	B2	B3	B4	B5	H	H1	H2	S	d
H-B 10 TBFH-LB 21	<b>70042400</b>	21		●	73	91	88,5			43						74,8			50	
H-B 10 TBFH-LB 29	<b>70042600</b>	29		●																
H-B 10 TBFH-LB M25	<b>79042400</b>		25		73	91	88,5			43						74,8			50	
H-B 10 TBFH-LB M32	<b>79042600</b>		32																	

Einsätze / Inserts / Inserts: 1.4: H-BE 10 / 1.5: H-EE 18 / 1.7: H-BVE 3 / 1.9: H-DD 42 / 1.10: MC 10

Kabelverschraubung / Cable gland / Presse-étoupe: 5.1: Metr. / 5.2: PG / 5.3: Kit

# 3.2 EPIC® D A - V I N C I H - B

Kupplungsgehäuse / Cable coupler hood / Capot prolongateur



PG



M

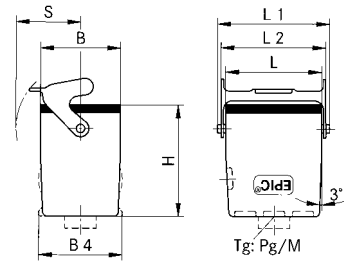

**EPIC® H-B Gehäuse: Kupplungsgehäuse (Kabeleingang gerade, Längsbügel, hohe Bauform)**

*EPIC® H-B housings: cable coupler hood (top entry, single locking lever, high version)*

*Boîtiers EPIC® H-B: capot prolongateur (sortie verticale, simple levier, version haute)*

## H-B 16

Artikel part article	Art.Nr. part No. N° art.	PG	M	ZW	L	L1	L2	L3	L4	B	B1	B2	B3	B4	B5	H	H1	H2	S	d
H-B 16 TBFH-LB 21	<b>70092200</b>	21		●	93,3	111	109,5			43						78,8			50	
H-B 16 TBFH-LB 29	<b>70092400</b>	29		●																
H-B 16 TBFH-LB M25	<b>79092200</b>		25		93,3	111	109,5			43						78,8			50	
H-B 16 TBFH-LB M32	<b>79092400</b>		32																	

Einsätze / Inserts / Inserts: 1.4: H-BE 16 / 1.5: H-EE 32 / 1.6: H-BS 6 / 1.7: H-BVE 6 / 1.8: H-D 40 / 1.9: H-DD 72 / 1.10: MC 16  
Kabelverschraubung / Cable gland / Presse-étoupe: 5.1: Metr. / 5.2: PG / 5.3: Kit

## H-B 24

Artikel part article	Art.Nr. part No. N° art.	PG	M	ZW	L	L1	L2	L3	L4	B	B1	B2	B3	B4	B5	H	H1	H2	S	d
H-B 24 TBFH-LB 21	<b>70142400</b>	21		●	120	138	136,5			43						78,8			50	
H-B 24 TBFH-LB 29	<b>70142600</b>	29		●																
H-B 24 TBFH-LB M25	<b>79142400</b>		25		120	138	136,5			43						78,8			50	
H-B 24 TBFH-LB M32	<b>79142600</b>		32																	

Einsätze / Inserts / Inserts: 1.4: H-BE 24 / 1.5: H-EE 46 / 1.7: H-BVE 10 / 1.8: H-D 64 / 1.9: H-DD 108 / 1.10: MC 24  
Kabelverschraubung / Cable gland / Presse-étoupe: 5.1: Metr. / 5.2: PG / 5.3: Kit



## 3.2 EPIC® D A - V I N C I H - B

Kupplungsgehäuse / Cable coupler hood / Capot prolongateur

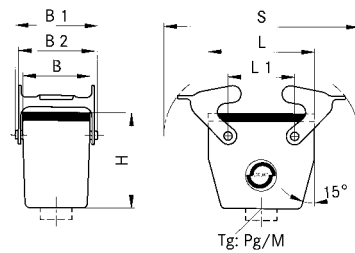

**EPIC® H-B Gehäuse: Kupplungsgehäuse (Kabeleingang gerade, Querbügel)**

*EPIC® H-B housings: cable coupler hood (top entry, double locking lever)*

*Boîtiers EPIC® H-B: capot prolongateur (sortie verticale, double levier)*

### H-B 10

Artikel part article	Art.Nr. part No. N° art.	PG	M	ZW	L	L1	L2	L3	L4	B	B1	B2	B3	B4	B5	H	H1	H2	S	d
H-B 10 TBF 16	<b>10046000</b>	16	●		73	27				43	57,8	53				54,8				116
H-B 10 TBF 21	<b>70040200</b>	21	●																	
H-B 10 TBF M20	<b>19046000</b>			20	73	27				43	57,8	53				54,8				116
H-B 10 TBF M25	<b>79040200</b>			25																

Einsätze / Inserts / Inserts: 1.4: H-BE 10 / 1.5: H-EE 18 / 1.7: H-BVE 3 / 1.9: H-DD 42 / 1.10: MC 10

Deckel / Cover / Couverture: 6.1: H-B 10

Kabelverschraubung / Cable gland / Presse-étoupe: 5.1: Metr. / 5.2: PG / 5.3: Kit

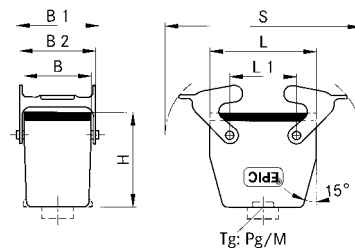
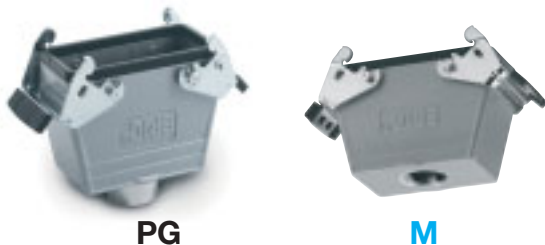

### H-B 16

Artikel part article	Art.Nr. part No. N° art.	PG	M	ZW	L	L1	L2	L3	L4	B	B1	B2	B3	B4	B5	H	H1	H2	S	d
H-B 16 TBF 21	<b>10086000</b>	21	●		93,3	47,5				43	57,8	53				63,6				136,5
H-B 16 TBF M25	<b>19086000</b>			25	93,3	47,5				43	57,8	53				63,6				136,5

Einsätze / Inserts / Inserts: 1.4: H-BE 16 / 1.5: H-EE 32 / 1.6: H-BS 6 / 1.7: H-BVE 6 / 1.8: H-D 40 / 1.9: H-DD 72 / 1.10: MC 16

Deckel / Cover / Couverture: 6.1: H-B 16

Kabelverschraubung / Cable gland / Presse-étoupe: 5.1: Metr. / 5.2: PG / 5.3: Kit

### H-B 24

Artikel part article	Art.Nr. part No. N° art.	PG	M	ZW	L	L1	L2	L3	L4	B	B1	B2	B3	B4	B5	H	H1	H2	S	d
H-B 24 TBF 21	<b>10127000</b>	21	●		120	74				43	57,8	53				63,8				163
H-B 24 TBF 29	<b>10117000</b>	29	●																	
H-B 24 TBF M25	<b>19127000</b>			25	120	74				43	57,8	53				63,8				163
H-B 24 TBF M32	<b>19117000</b>			32																

Einsätze / Inserts / Inserts: 1.4: H-BE 24 / 1.5: H-EE 46 / 1.7: H-BVE 10 / 1.8: H-D 64 / 1.9: H-DD 108 / 1.10: MC 24

Deckel / Cover / Couverture: 6.1: H-B 24

Kabelverschraubung / Cable gland / Presse-étoupe: 5.1: Metr. / 5.2: PG / 5.3: Kit

## 3.2 EPIC® D A - V I N C I H - B

Kupplungsgehäuse / Cable coupler hood / Capot prolongateur



PG



M

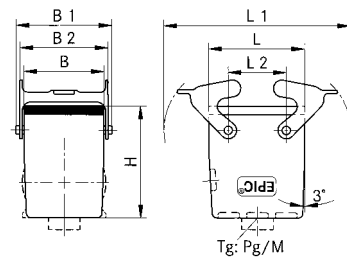

**EPIC® H-B Gehäuse: Kupplungsgehäuse (Kabeleingang gerade, Querbügel, hohe Bauform)**

*EPIC® H-B housings: cable coupler hood (top entry, double locking lever, high version)*

*Boîtiers EPIC® H-B: capot prolongateur (sortie verticale, double levier, version haute)*

### H-B 10

Artikel part article	Art.Nr. part No. N° art.	PG	M	ZW	L	L1	L2	L3	L4	B	B1	B2	B3	B4	B5	H	H1	H2	S	d
H-B 10 TBFH 21	<b>70040400</b>	21		●	73	27				43	57,8	53				74,8				116
H-B 10 TBFH 29	<b>70040600</b>	29		●																
H-B 10 TBFH M25	<b>79040400</b>		25		73	27				43	57,8	53				74,8				116
H-B 10 TBFH M32	<b>79040600</b>		32																	

Einsätze / Inserts / Inserts: 1.4: H-BE 10 / 1.5: H-EE 18 / 1.7: H-BVE 3 / 1.9: H-DD 42 / 1.10: MC 10

Deckel / Cover / Couvercle: 6.1: H-B 10

Kabelverschraubung / Cable gland / Presse-étoupe: 5.1: Metr. / 5.2: PG / 5.3: Kit



PG



M

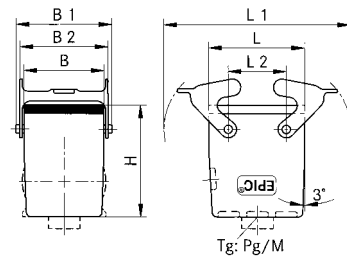

### H-B 16

Artikel part article	Art.Nr. part No. N° art.	PG	M	ZW	L	L1	L2	L3	L4	B	B1	B2	B3	B4	B5	H	H1	H2	S	d
H-B 16 TBFH 21	<b>70090200</b>	21		●	93,3	47,5				43	57,8	53				78,8				136,5
H-B 16 TBFH 29	<b>70090400</b>	29		●																
H-B 16 TBFH M25	<b>79090200</b>		25		93,3	47,5				43	57,8	53				78,8				136,5
H-B 16 TBFH M32	<b>79090400</b>		32																	

Einsätze / Inserts / Inserts: 1.4: H-BE 16 / 1.5: H-EE 32 / 1.6: H-BS 6 / 1.7: H-BVE 6 / 1.8: H-D 40 / 1.9: H-DD 72 / 1.10: MC 16

Deckel / Cover / Couvercle: 6.1: H-B 16

Kabelverschraubung / Cable gland / Presse-étoupe: 5.1: Metr. / 5.2: PG / 5.3: Kit

## 3.2 EPIC® D A - V I N C I H - B

Kupplungsgehäuse / Cable coupler hood / Capot prolongateur



PG



M

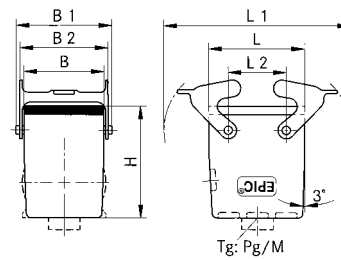

**EPIC® H-B Gehäuse: Kupplungsgehäuse (Kabeleingang gerade, Querbügel, hohe Bauform)**

*EPIC® H-B housings: cable coupler hood (top entry, double locking lever, high version)*

*Boîtiers EPIC® H-B: capot prolongateur (sortie verticale, double levier, version haute)*

### H-B 24

Artikel part article	Art.Nr. part No. N° art.	PG	M	ZW	L	L1	L2	L3	L4	B	B1	B2	B3	B4	B5	H	H1	H2	S	d
H-B 24 TBFH 21	<b>70140400</b>	21	●		120	74				43	57,8	53				78,8				163
H-B 24 TBFH 29	<b>70140600</b>	29	●																	
H-B 24 TBFH M25	<b>79140400</b>			25	120	74				43	57,8	53				78,8				163
H-B 24 TBFH M32	<b>79140600</b>			32																

Einsätze / Inserts / Inserts: 1.4: H-BE 24 / 1.5: H-EE 46 / 1.7: H-BVE 10 / 1.8: H-D 64 / 1.9: H-DD 108 / 1.10: MC 24

Deckel / Cover / Couverture: 6.1: H-B 24

Kabelverschraubung / Cable gland / Presse-étoupe: 5.1: Metr. / 5.2: PG / 5.3: Kit



PG



M

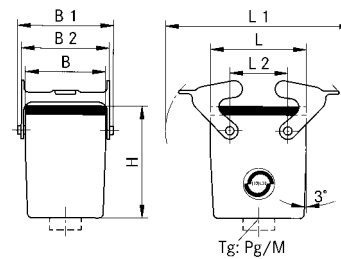

### H-B 32

Artikel part article	Art.Nr. part No. N° art.	PG	M	ZW	L	L1	L2	L3	L4	B	B1	B2	B3	B4	B5	H	H1	H2	S	d
H-B 32 TBFH 29	<b>10139500</b>	29	●		93,5	64,5				79	93,8	87,8				97	5			136,5
H-B 32 TBFH M32	<b>19139500</b>			32	93,5	64,5				79	93,8	87,8				97	5			136,5

Einsätze / Inserts / Inserts: 1.4: H-BE 32 / 1.5: H-EE 64 / 1.6: H-BS 12 / 1.8: H-D 80 / 1.9: H-DD 144 / 1.10: 2 x MC 16

Kabelverschraubung / Cable gland / Presse-étoupe: 5.1: Metr. / 5.2: PG / 5.3: Kit

# 3.2 EPIC® D A - V I N C I H - B

## Tüllengehäuse / Hood / Capot

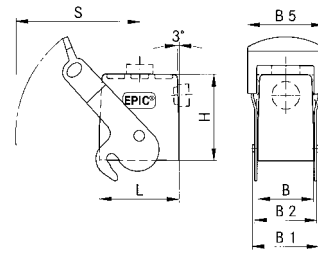

### EPIC® H-B Gehäuse: Tüllengehäuse mit Zentralbügel

EPIC® H-B housings: hood with central lever

Boîtiers EPIC® H-B: capot avec levier central

#### H-B 16

Artikel part article	Art.Nr. part No. N° art.	PG	M	ZW	L	L1	L2	L3	L4	B	B1	B2	B3	B4	B5	H	H1	H2	S	d
H-B 16 TSH-ZB	<b>70124200</b>	21			93,3					43						76				

Einsätze / Inserts / Inserts: 1.4: H-BE 16 / 1.5: H-EE 32 / 1.6: H-BS 6 / 1.7: H-BVE 6 / 1.8: H-D 40 / 1.9: H-DD 72 / 1.10: MC 16

Deckel / Cover / Couvercle: 6.1: H-B 16

Kabelverschraubung / Cable gland / Presse-étoupe: 5.1: Metr. / 5.2: PG / 5.3: Kit

#### H-B 24

Artikel part article	Art.Nr. part No. N° art.	PG	M	ZW	L	L1	L2	L3	L4	B	B1	B2	B3	B4	B5	H	H1	H2	S	d
H-B 24 TSH-ZB	<b>70174400</b>	21			120					43						76				
H-B 24 TSH-ZB	<b>70174200</b>	29																		

Einsätze / Inserts / Inserts: 1.4: H-BE 24 / 1.5: H-EE 46 / 1.7: H-BVE 10 / 1.8: H-D 64 / 1.9: H-DD 108 / 1.10: MC 24

Deckel / Cover / Couvercle: 6.1: H-B 24

Kabelverschraubung / Cable gland / Presse-étoupe: 5.1: Metr. / 5.2: PG / 5.3: Kit

# 3.2 EPIC® D A - V I N C I H - B

Anbaugehäuse / Panel mount base / Embase encastrée

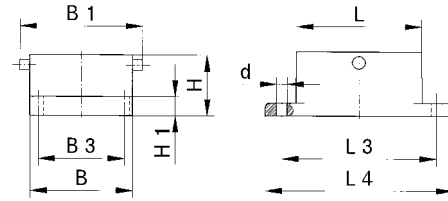

## EPIC® H-B Gehäuse: Anbaugehäuse für Zentralbügel

EPIC® H-B housings: panel mount base for central lever

Boîtiers EPIC® H-B: embase encastrée pour levier centralement

### H-B 16

Artikel part article	Art.Nr. part No. N° art.	PG	M	ZW	L	L1	L2	L3	L4	B	B1	B2	B3	B4	B5	H	H1	H2	S	d
H-B 16 AG-ZR	<b>70084000</b>				93,3			103	113	43	57,8	53	32			27,8	4			

Einsätze / Inserts / Inserts: 1.4: H-BE 16 / 1.5: H-EE 32 / 1.6: H-BS 6 / 1.7: H-BVE 6 / 1.8: H-D 40 / 1.9: H-DD 72 / 1.10: MC 16

Deckel / Cover / Couvercle: 6.1: H-B 16

Kabelverschraubung / Cable gland / Presse-étoupe: 5.1: Metr. / 5.2: PG / 5.3: Kit

### H-B 24

Artikel part article	Art.Nr. part No. N° art.	PG	M	ZW	L	L1	L2	L3	L4	B	B1	B2	B3	B4	B5	H	H1	H2	S	d
H-B 24 AG-ZR	<b>70134000</b>				120			130	140	43	57,8	53	32			27,8	4			

Einsätze / Inserts / Inserts: 1.4: H-BE 24 / 1.5: H-EE 46 / 1.7: H-BVE 10 / 1.8: H-D 64 / 1.9: H-DD 108 / 1.10: MC 24

Deckel / Cover / Couvercle: 6.1: H-B 24

Kabelverschraubung / Cable gland / Presse-étoupe: 5.1: Metr. / 5.2: PG / 5.3: Kit